

Quality products for
the offshore & fishing
industry since 1963

Kunnskap og erfaring gir tryggere løft

Velkommen til Møllerodden

Møllerodden AS har siden 1963 levert produkter av høy kvalitet til offshorenæringen verden over. Det er ikke uten grunn at **Møllerblokk** er blitt et begrep i bransjen. Vår erfaring og kunnskap gir våre kunder trygge produkter av høy kvalitet.

Vi er totalleverandør av blokker og leverer alt fra standardiserte produkter til produkter som er skreddersydd etter kundens ønske.



Møllerodden AS er i dag eid av Brødr. Haukås Mek. Verksted AS. Brødrene Haukås har i alle år vært samarbeidspartner og produsent av våre produkter og er det fremdeles. Nær kjennskap til kompetansen som ligger bak produksjonen gjør også at vi kan garantere for våre produkter.

På de neste sidene følger en oversikt over våre standardiserte produkter og eksempler fra prosjekter. Teksten vil heretter være på engelsk.

MØLLERODDEN^{AS}





Welcome to Møllerodden

Møllerodden AS has delivered quality products to offshore industry all over the world since 1963. The fact that **Møllerblokk** has become a term in the industry is no coincidence. Our experience and knowledge give our customers high quality products, manufactured according to stringent safety requirements.

We deliver all types of blocks. A wide range of standard blocks is available, but we also deliver custom made blocks designed and manufactured according to customer specifications.

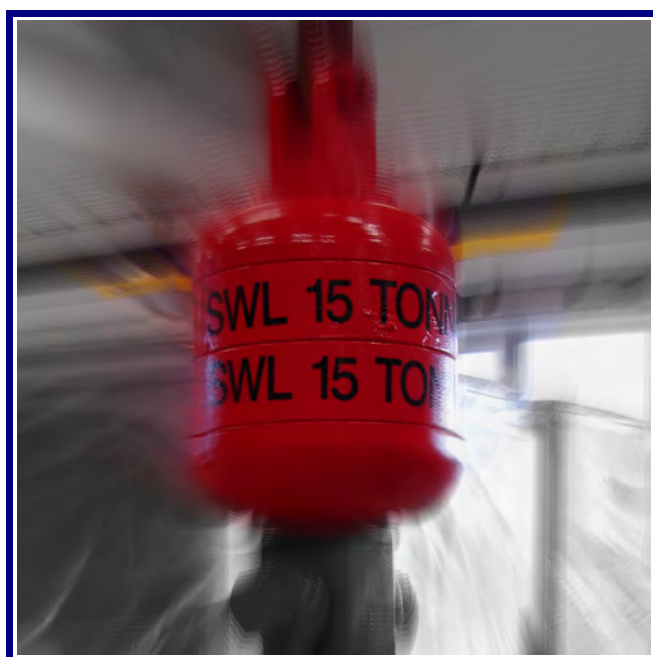

Today **Møllerodden AS** is owned by Brødrene Haukås Mek. Verksted AS. Brødrene Haukås has been our cooperative partner and the manufacturer of our products for many years, and still is. Our knowledge of the entire line of production and the proficiency behind it is fundamental in order to guarantee the quality of our products.

This brochure contains a presentation of our standard products. We will also show you some examples from projects.





Products

On the following pages, we present the standard products from **Møllerodden AS**. These products can be delivered within a relatively short time frame.



All of our blocks are delivered with a certificate. If you do not find what you are looking for, please contact us as we can design our products after any specification you might have.



Single sheaved Blocks B1 and F1

Single sheaved Block B1

The B1-series is a standardized block for lifts where the housing is casted from one piece.

SWL: 1 – 6 ton/tons

Wire diameter: 10 – 16 mm

Outer diameter wire-sheave: 4", 6", 9", 12", 14" and 16"

SWL equals the pull of the wire.



B1-series



Oval eye

The blocks can be delivered with oval eye, stud eye or jaw.

Single sheaved Block F1

F1 is a standardised block for lifts which is based on steel plates from the B1-series.

SWL: 10 – 16 tons

Wire diameter: 10 – 16 mm

Outer diameter wire-sheave: 16", 18" and 20"

SWL equals the pull of the wire. For more technical specifications, see our appendix.



F1-series

Double sheaved Blocks B2/F2

Double sheaved Block B2

The B2-series is a standardized block for lifts where the housing is casted.

SWL: 4 tons

Wire diameter: 10 – 16 mm

Outer diameter wire-sheave: 4" and 6"

SWL equals the pull of the wire.



B2-series

Double sheaved Block F2:

F2 is a standardized block based on steel plates from the B1-series.

SWL: 12 – 50 tons

Wire diameter: 14 – 32 mm

Outer diameter wire-sheave: 9", 12", 14", 16", 18" and 20"

SWL equals the pull of the wire.

Both B2 and F2 can be delivered with oval eye, stud eye and jaw. For more technical specifications, see our appendix.

Lower Cargo Blocks with Hook

Weights are added according to customers specifications.

Lifting capacity SWL: 2 – 10 tons

Wire diameter: 14 – 32 mm

Outer diameter wire-sheave: 16", 18" and 20"

Cargo blocks are delivered with a hook depending on customers request. For technical specifications, see our appendix.

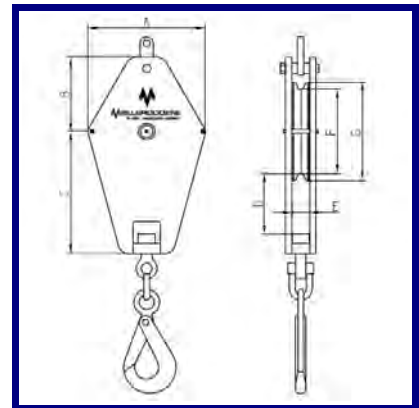

Snatch Block

The Snatch Blocks have 2 different locking mechanisms depending on its size.

SWL: 2 – 15 tons

Wire diameter: 10 – 16 mm

Outer diameter wire-sheave: 16", 18" and 20"

SWL equals the pull of the wire. The blocks can be delivered with oval eye, stud eye or jaw.

For further details and technical specifications, see our appendix.



Wire-sheaves

Møllerodden AS has a big selection of regular wire-sheaves and trawl-sheaves. For further details and technical specifications, see our appendix.





Trawl Blocks

SWL: 4 – 120 tons
Wire diameter: mm

SWL equals the pull of the wire. The blocks can be delivered with oval, eye, stud eye or jaw. For technical specifications, see our appendix.



Below: Trawl blocks ready for shipping



The 30000-series

Model 30101-13:

Single sheaved
Cargo Block
WLL: 3 tons in
wire
WLL: 6 tons in
hook for \varnothing 13mm
wire

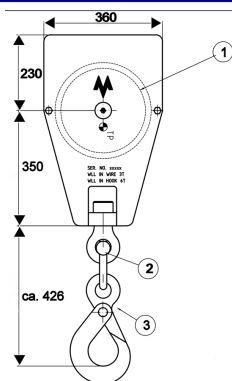

Model 32103:

Single sheaved
block
SWL: 6 tons
With chain and
hook
SWL: 12 tons in
hook
 \varnothing 18mm wire

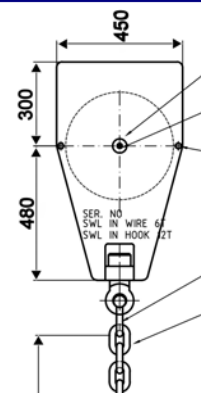

Model 33223

Double sheaved
block with chain
and hook.
For \varnothing 20mm wire
SWL: 25 tons
25 tons in single
hook.

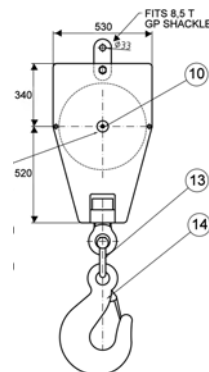
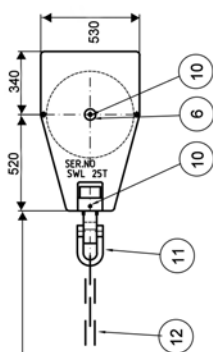

Model 34142

Single sheaved
block with bucket
SWL: 8,3 tons in
wire
SWL: 25 tons in
eye
 \varnothing 22 mm wire

Model 35111

Single sheaved
block
WLL: 10 tons
WLL: 20 tons in
hook
For 24mm wire

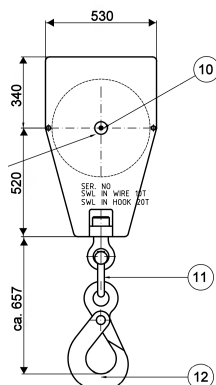

For technical
specifications
regarding our 30000-
series, see our
appendix.

Tow-handling and Riser/Puller-system

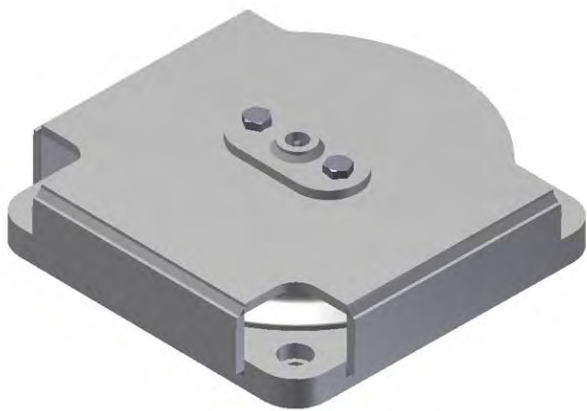

Block A3 -1782



Block A3 -1826



Flag block A3 1937



Block A3-0380-1-180



Block B1-6"



Products and Projects

At **Møllerodden AS**, we are prepared to meet whatever demand our customer might have. Our goal is to achieve the best solutions for our customers and meet quality and safety requirements.

We take pride in our products and the process of making them. We follow our customers all the way, from the initial concept to the delivery of a finished product. No product or project is considered complete before we have met all the expectations from our customer.



Below: Guide arrangement for ankerhandling

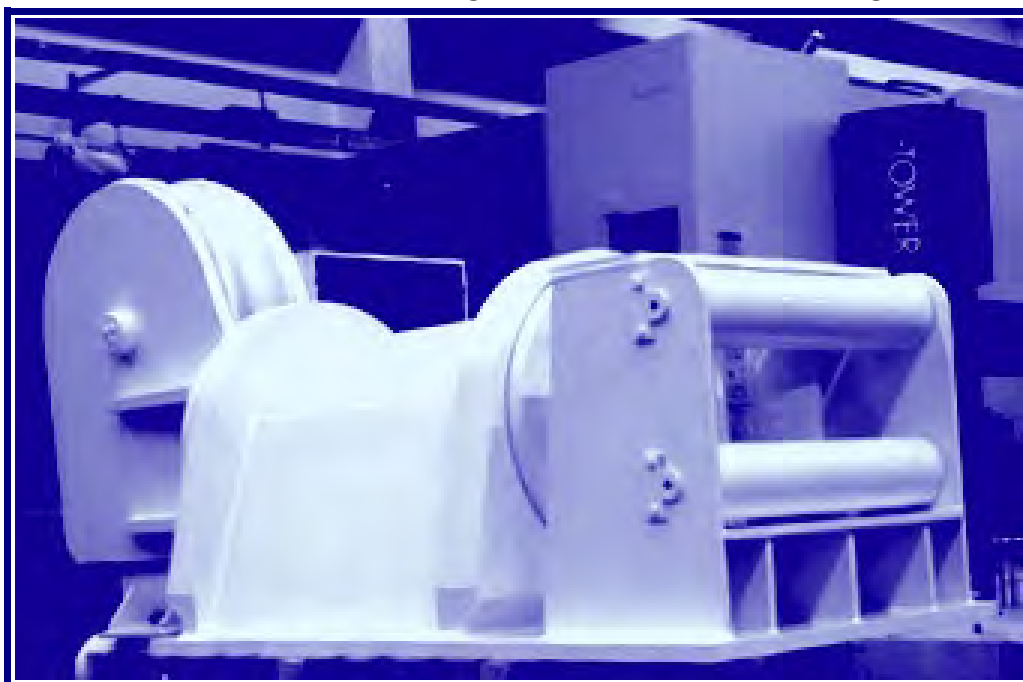

Project: Goliat

Møllerodden AS was proud to deliver guide rollers for the Goliat-platform which has a planned start of production in the Barents Sea in 2014.



For customer by Møllerodden AS

Below: Single sheave rams-horn hook block SWL 22.5 tons (right) and swivel with hook SWL 15 tons (left)



Below: Single sheaved rams-horn block

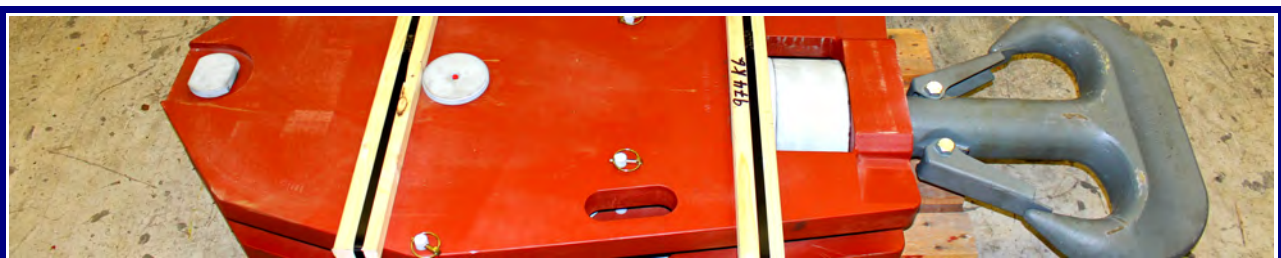



Below: Five sheaved block

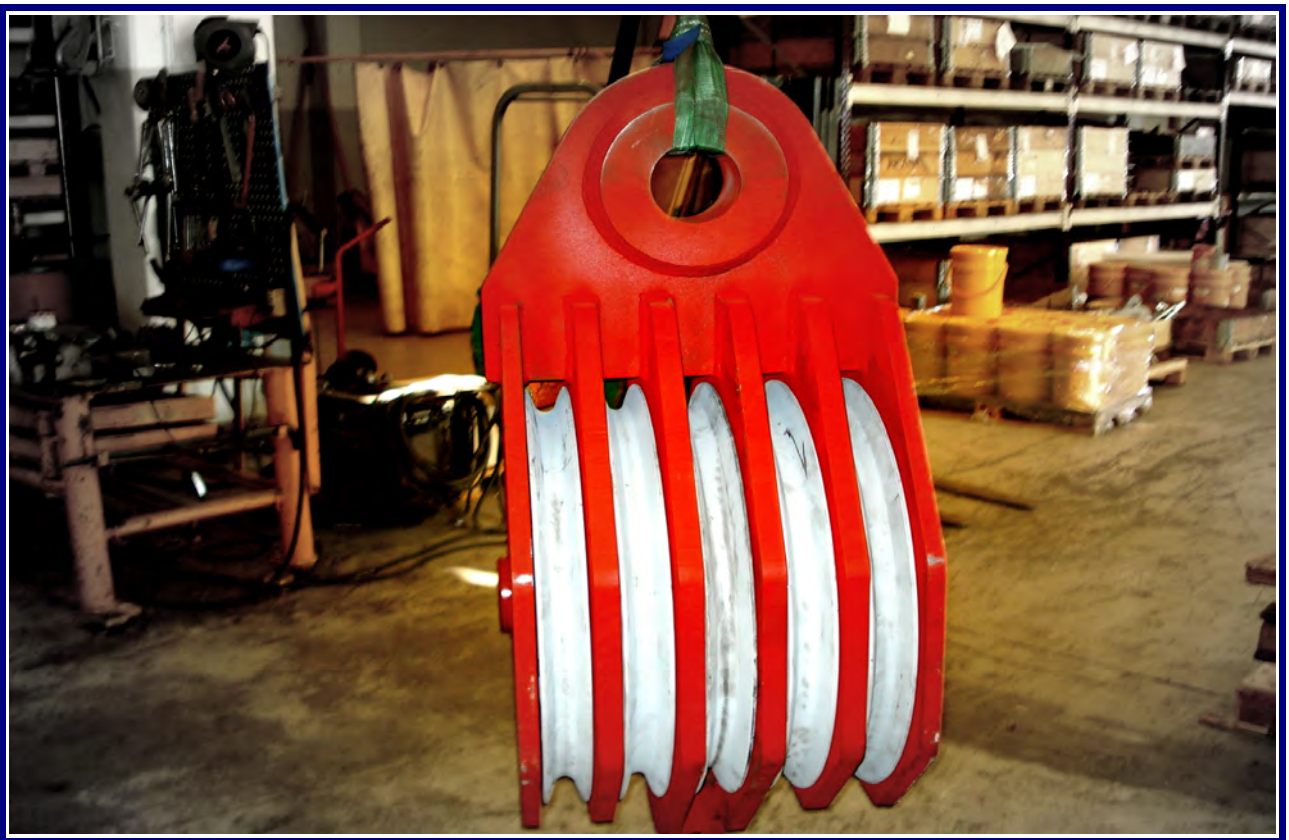

Below: Single sheaved hook block with SWL 45 tons





Møllerodden Certification AS

Møllerodden AS has established subsidiary in cooperation with engineer Jon Kristian Simonsen: **Møllerodden Certification AS**. The company will be offering certification and recertification of lifting-equipment, onshore and offshore. The shareholders in **Møllerodden Certification AS** are Engineer Jon Kristian Simonsen and Møllerodden AS, each holding 50% of the shares. Jon Kristian Simonsen is an approved certification expert.

Møllerodden Certification AS perform certification of all kinds of lifting equipment. We can test and approve test loads for cranes.



Møllerodden Certification AS are able to certify winches, wires, blocks and hooks in our own testing area. We can also bring our test equipment to do the testing on site.

With **Møllerodden Certification AS**, we wish to have a complete range of services for our customers with engineering, product development, manufacturing and certification of equipment. **Møllerodden Certification AS** will have the same first priorities as **Møllerodden AS** products: Quality and safety.



Møllerodden Certification AS also offers service and maintenance for lifting equipment and winches. Test rig for wiring is being designed. (2500 tons.)



Contact:

Jon Kristian Simonsen, competent person/ inspector: **0047 91 77 61 23**

Øyvind Bjørnevik, sales manager/ inspector: **0047 91 81 55 75**

Office: 0047 52 70 31 00





The owner of Møllerodden:
Brødrene Haukås Mek. Verksted AS



Brødrene Haukås Mek. Verksted AS was established in 1966 and we have years of experience in manufacturing mechanical products. We produce pistons, cylinders, valves, parts for hydraulic engines and a wide range of other products. In most cases we work with projects that demand high precision in execution.

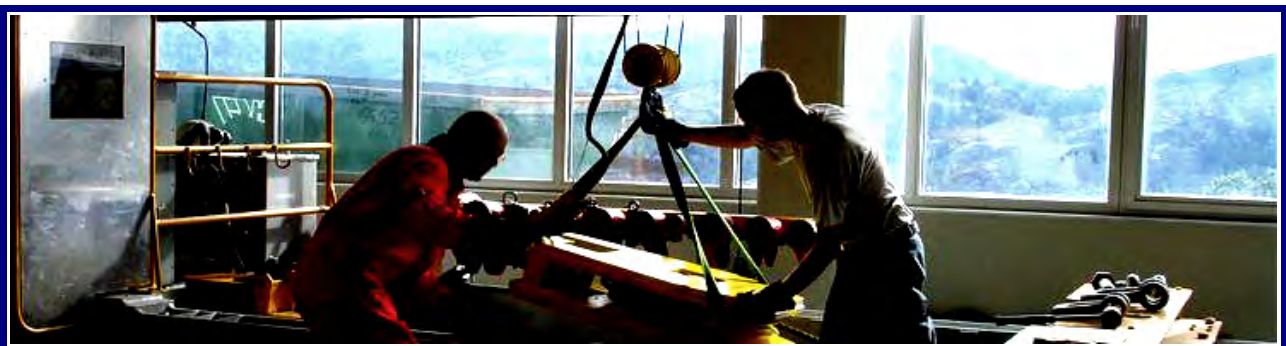



Brødrene Haukås Mek. Verksted AS has 23 employees and our competence is solid. We do turning, milling, welding and assembling. We take pride in what we do and the products we manufacture.



Bucket for an excavator

At **Brødrene Haukås Mek. Versted AS**, high quality is our strength. We can guarantee this quality thanks to our highly competent staff, experience and machinery.





Our machine workshop is 2400 square meter and we have a big selection of machinery to manufacture various products. Some of our machinery are pictured below:



Integrex E-500-II, CNC operated

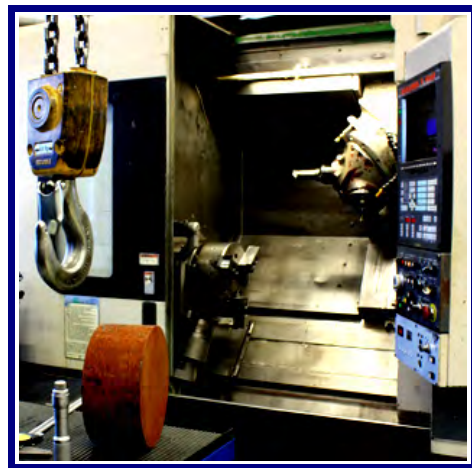

Integrex 50



Gildemeister: Max Müller MDW 40 U



Quick Turn Smart 350M

Credits

We would like to thank **Kåre Grunnevåg** who has been with Møllerodden AS since 1963. His commitment to the company and his knowledge has made Møllerodden AS what it is today. Kåre Grunnevåg retired in 2012, but is still giving his valuable advice if we need it. There is after all, a reason that he is called “Mr. Møllerodden”.



Kåre Grunnevåg (right) and managing director Egil Skjølingstad (left) beside a product from Møllerodden ready for shipping.



Thank you for your interest in **Møllerodden AS** products. We remind you that if you do not find what you are looking for, or you need further details and information, please contact us. We will be happy to answer any question you might have. In our appendix you will find further details and technical specifications regarding our products.

Contact information:

Telephone: (+47) 52 70 31 00

Fax: 52 70 31 25

E-mail: post@mollerodden.no

Address: Longhammarvegen 15, 5536 Haugesund



This Catalogue is made exclusively for Møllerodden AS by Silje Bjørnevik

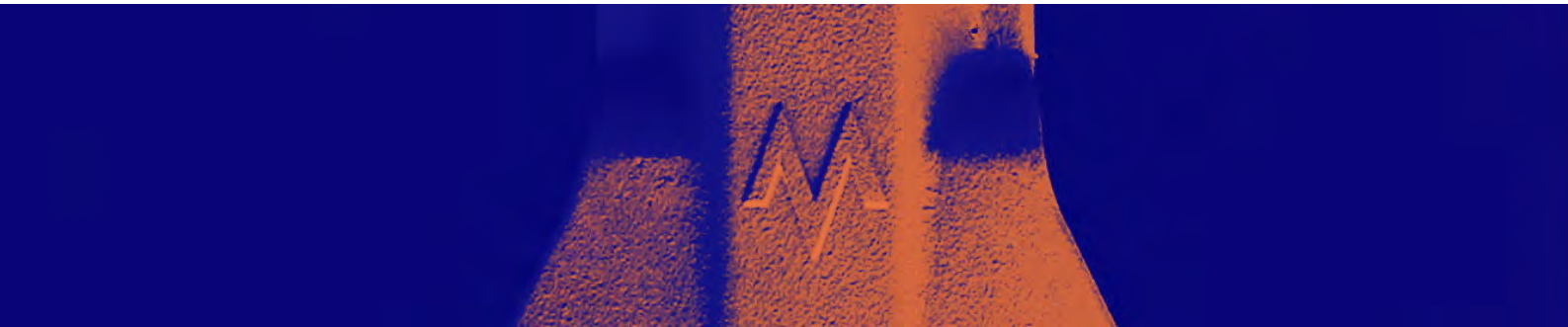

Appendix

Møllerodden products

technical
specifications



We wish to give the following information regarding blocks as a guide, without prejudice.

SWL: For definition of SWL see page 2
 Blocks are generally tested and marked according to the Norwegian Maritime Directorate' rules and regulations, July 17. 1978.

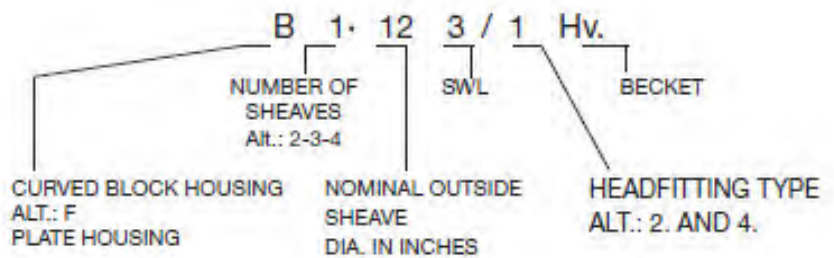

See drawing of **10 Ton Derrick Rig** shown below as an example only. Cargo runner

Ø24mm. Span rope Ø18, Slewing Guy Wire Ø14.

Item 1. Heel Block
 Fitted with stud eye to suit a spring loaded self adjusting heeblock assembly, which will keep the block in correct position until derrick angle is altered, thereby avoiding the block to fall down and turn over when cargowire is unloaded.
 Code: F1-166/2.

Item 2. Top Block
 Fitted with a stud eye to suit the bolt and gap of a shackle.
 Code: F1-166/2 Hv.

Item 3. Lower Cargo Block
 Fitted with Swivel Hook. The block has to be heavy enough to pull out the wire with empty hook and preferably of an anti toppling type.
 Code: F1-166/5L.

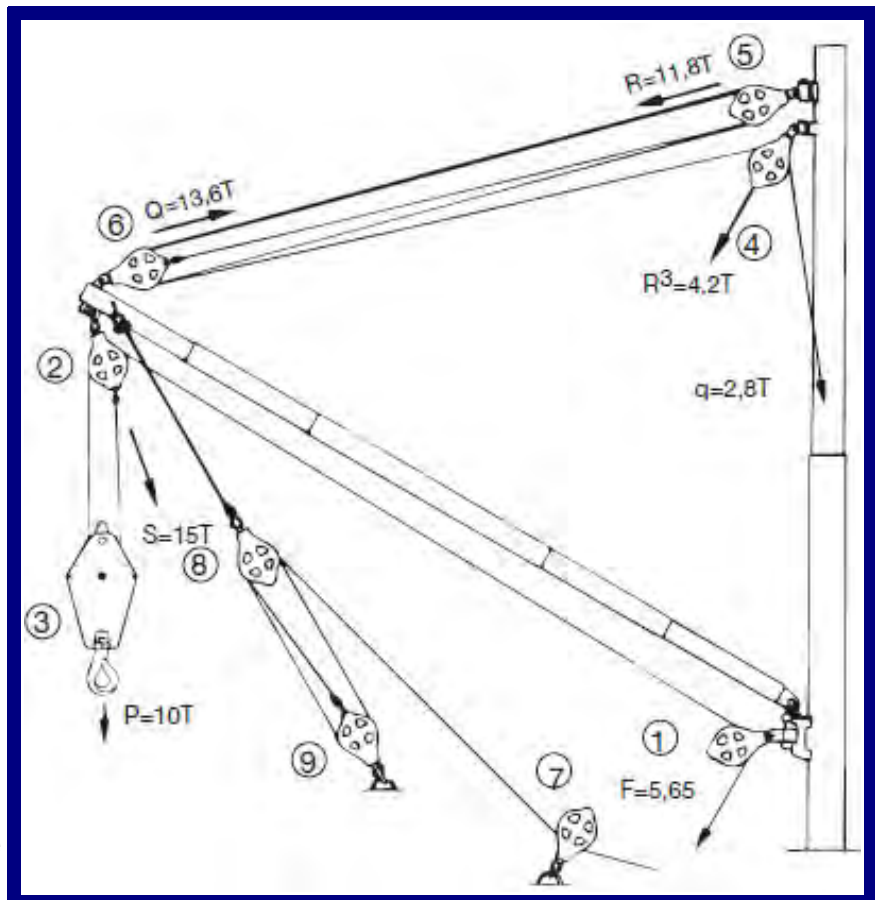

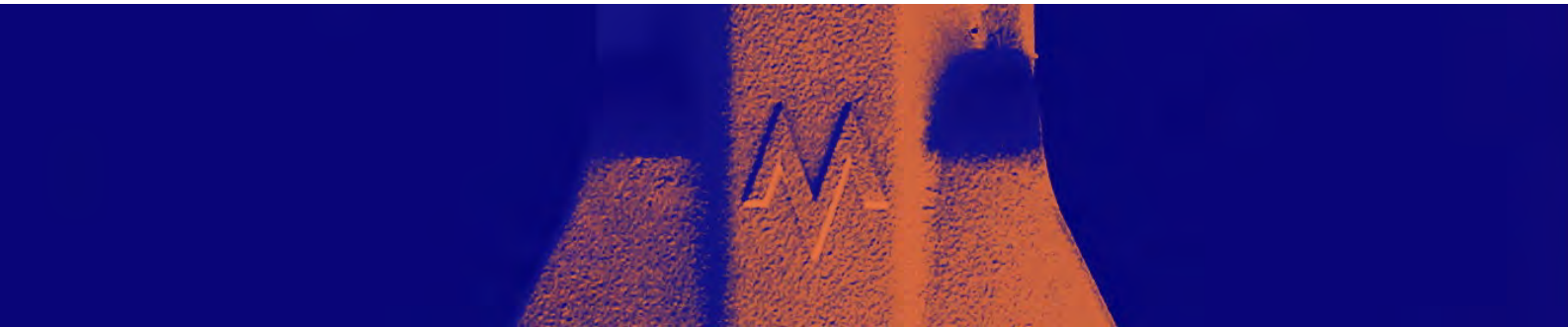

Item 4. Singl. Span Block

On mast, fitted with jaw. Code: B1-123/4.

Item 5. Double SpanBlock

On mast, fitted with fixed jaw to prevent twisting of Span Wire. Code: F2-1212/4F.

Item 6. Derrick Head Span Block

Double sheaved fitted with becket and fixed jaw to prevent twisting of span rope.
Code: F2-1216/4F, Hv.

Slewing Guy Blocks are normally fitted with swivel stud eyes to take shackle pins.

Item 7. Slewing Guy

Lead Block. Code: B1-92/2.

Item 8. Upper Slewing Guy Block

Double sheaved. Code: F2-98/2

Item 9. Lower Slewing Guy Block

Single sheaved with becket. Code: B1-92/2 Hv.

Shackles

Shackles are to be of non agein steel and be furnished with nut and cotter pin.They are to be tested and a test certificate are to be issued. It shall also be correctly fitted both in the block head fitting and in fittings onboard.

According to «standard for certification of lifting appliances” DNV 2.22

-Advised groove radius is $0,53xd$
(d =nominal rope diameter) and should be between $0,52d < r < 0,57d$

-Normally the sheave diameter for steel wire ropes shall at least correspond to a ratio $Dp/d=18$
(Dp = pitch diameter)

All Møllerblocks are certified and marked according to the Norwegian Maritime Directorates’s rules of 1978.

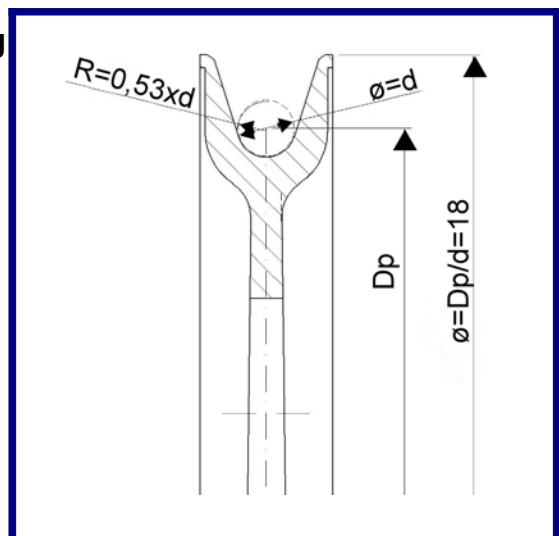

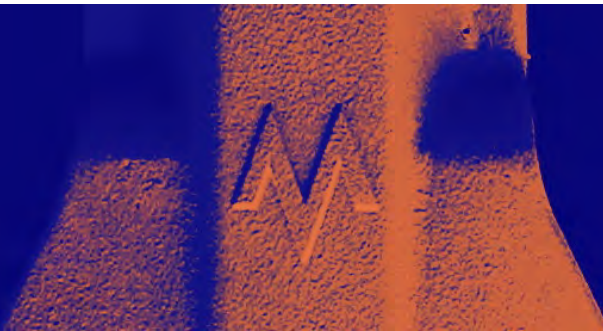

Extract from the Norwegian Maritime Directorate's regulations:

§13. Loose gear.

13.1: Test loads

Before it is first taken into use, and after it has been altered or repaired, every item of loose shall be tested with the following test loads: Chain, ring, hook, schackle, swivel, multiple sheave block.

Up to and incl.	2*SWL	Up to and incl.	2*SWL
25 tons	55 tons	100 tons	155 tons
30 tons	65 tons	110 tons	165 tons
35 tons	70 tons	120 tons	175 tons
40 tons	75 tons	130 tons	190 tons
45 tons	85 tons	140 tons	200 tons
50 tons	90 tons	150 tons	215 tons
55 tons	95 tons	160 tons	230 tons
60 tons	100 tons	170 tons	240 tons
65 tons	110 tons	180 tons	145 tons
70 tons	115 tons	180 tons	1,33*SWL
75 tons	120 tons	Single sheaved block 2)	4* SWL
80 tons	125 tons	Single sheaved block with becket 2)	6* SWL
85 tons	130 tons	Wire rope 3)	Breaking load
90 tons	135 tons	Yoke or similar 4)	2,0*SWL
95 tons	145 tons		

1) For multiple sheave blocks, the permitted working load (SWL) is equal to the resultant load in the head fitting. See also § 12.2

2) For single sheave block with or without becket, the test load may be reduced in accordance with the above table when the resultant load in the head fitting exceeds 25 tons.

3) Every length and dimensions shall be tested. If there is no possibility of testing a complete piece, threads or parts may be tested till breakage and the strength be calculated.

4) Yokes and similar with a permitted working load (SWL) of more than 20 tonnes, may be tested together with the cargo handling gear.



Extract from the Norwegian Maritime Directorate's regulations:

15.5 Blocks

15.5.1

Safe working load (SWL) for a single sheave block is equal to the wire pull (i.e. Half the force on the suspension link) when the block is used as a single loading block. For a single sheave block with becket, SWL is also equal to the wire pull which, in this case, is on third of the force on the suspension link. In both cases, the block shall be marked with SWL = the wire pull.

15.5.2

For a multiple sheave block, SWL is equal to the force on the the suspension link, and equal to the SWL with wich the block shall be marked.

15.6

Chain, rings, hooks, shackles, swivels, etc. shall be marked with the maximum permitted safe working load, and an identification number in the Certificate.

Index

Single Sheaved Blocks B1	Page 29
Single Sheaved Blocks F1	Page 31
Double Sheaved Blocks B2 and F2	Page 32
Lower Cargo Block	Page 34
Snatch Block	Page 35
Trawl Block	Page 36
Standard Wire-sheaves	Page 38
Wire-sheaves in other dimensions	Page 39
Multipurpose Wire-sheaves	Page 41
Sound Cable Block	Page 42
Manrider Block	Page 43
The 3000-series	Page 44
Examples of other products	Page 51

Single sheaved Blocks B1

B1- 4", B1- 6", B1- 9", B1- 12" and B1- 16":

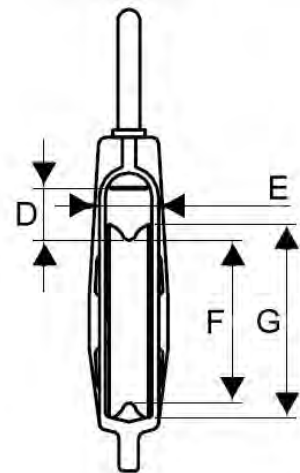
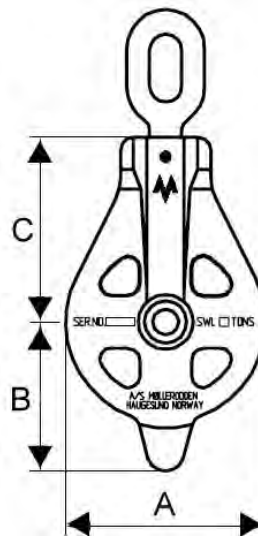
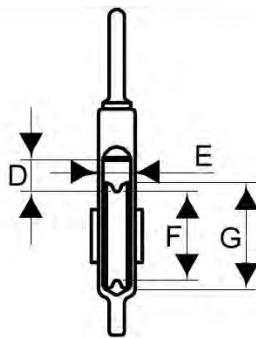
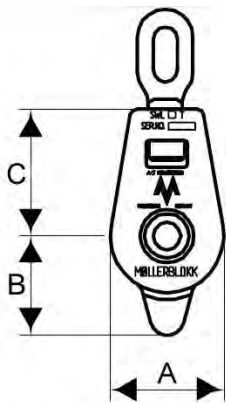

Block Code	SWL tons	Max. Load on head-fitting	Wire Dia. mm	A	B	C	D	E	F	G	Weight Kg
B1- 4"	1	2	12	110	100	140	55	28	80	100	5
B1- 6"	2	4	10	167	145	185	43	41	130	155	10
B1- 9"	3	6	14	240	180	235	60	40	195	230	18
B1- 12"	5	10	18	310	230	285	80	71	250	300	32
B1- 14"	6	12	20	365	255	300	75	71	290	355	39
B1- 16"	6	12	24	410	280	340	90	71	340	400	43



Single sheaved Blocks B1

Block Code	SWL Ton	Load test	Load on headfittings Ton	Wire diameter mm	Weight Kg
B1 - 41	1	4	2	12	5
B1 - 41 hv	1	6	3	12	5
B1 - 61 hv	1	4	2	10	10
B1 - 62	2	8	4	10	10
B1 - 62 hv	2	12	6	10	10
B1 - 92	2	8	4	14	18
B1 - 92 hv	2	12	6	14	18
B1 - 93	3	12	6	14	18
B1 - 122 hv	2	12	6	18	32
B1 - 123	3	12	6	18	32
B1 - 124	4	16	8	18	32
B1 - 123 hv	3	18	9	18	32
B1 - 125	5	20	10	18	32
B1 - 143	3	12	6	20	39
B1 - 144	4	16	8	20	39
B1 - 143 hv	3	18	9	20	39
B1 - 145	5	20	10	20	39
B1 - 144 hv	4	24	12	20	39
B1 - 146	6	24	12	20	39
B1 - 163	3	12	6	24	43
B1 - 164	4	16	8	24	43
B1 - 163 hv	3	18	9	24	43
B1 - 165	5	20	10	24	43
B1 - 164 hv	4	24	12	24	43
B1 - 166	6	24	12	24	43

Single sheaved Blocks F1

F1- 16", F1- 18" and F1- 20":

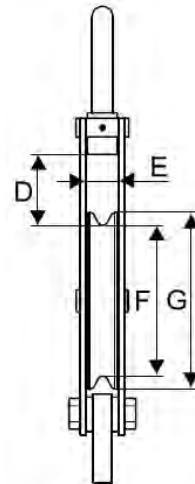
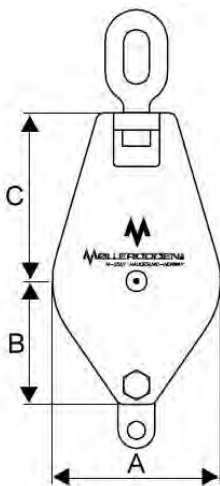

Block Code	SWL tons	Max. Load on head-fitting	Wire Dia. mm	A	B	C	D	E	F	G	Weight Kg
F1- 16"	10	20	26	420	320	450	175	85	335	400	105
F1- 18"	10	20	28	480	355	485	190	85	400	470	145
F1- 20"	16	32	32	520	380	510	155	80	445	515	190

Block Code	SWL Ton	Load Test	Load on headfittings Ton	Wire diameter mm	Weight Kg
F1 - 168	8	32	16	26	105
F1 - 166 hv	6	36	18	26	105
F1 - 1610	10	40	20	26	105
F1 - 188	8	32	16	28	145
F1 - 186 hv	6	36	18	28	145
F1 - 1810	10	40	20	28	145
F1 - 2010	10	40	20	32	190
F1 - 2015	15	55	30		
F1 - 2016	16	65	32		

Double sheaved Blocks B2 and F2

B2- 4" and B2- 6":

F2- 9" to F2- 20":

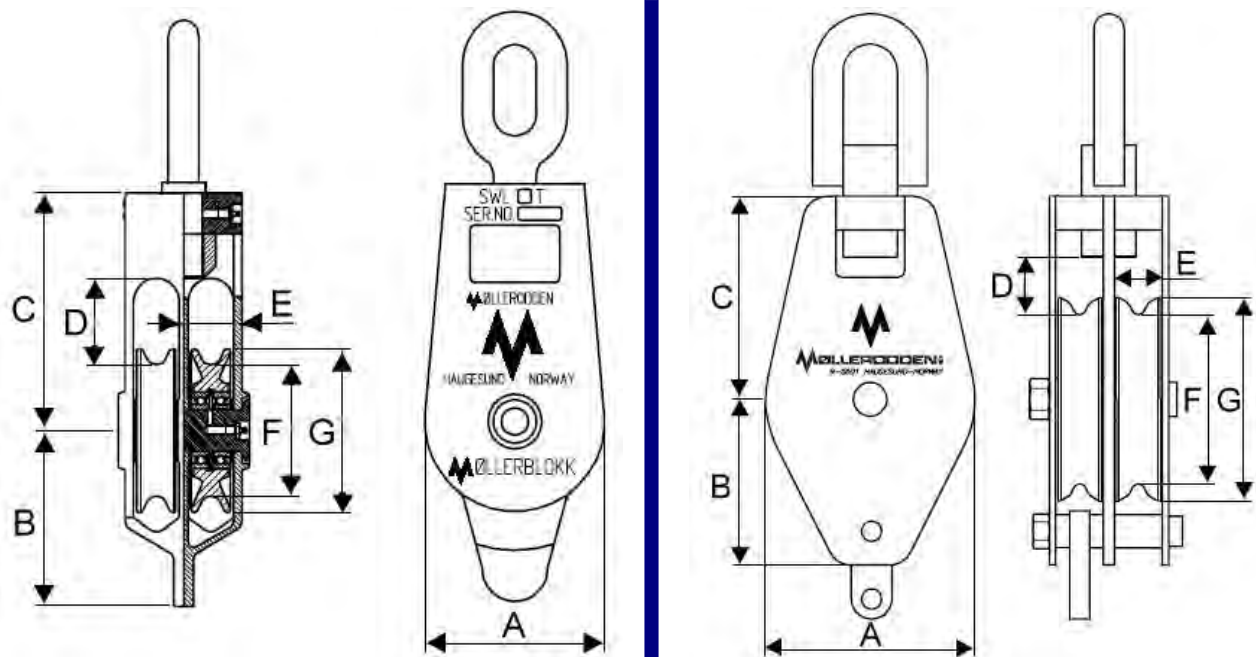

Block Code	SWL tons	Max. Load on head-fitting	Wire Dia. mm	A	B	C	D	E	F	G	Weight Kg
B2- 4"	4	4	12	110	110	145	54	28	80	100	7,5
B2- 6"	8	8	10	166	140	185	47	41	130	155	21

Block Code	SWL tons	Max. Load on head-fitting	Wire Dia. mm	A	B	C	D	E	F	G	Weight Kg
F2- 9"	12	12	14	250	180	235	65	46	190	230	40
F2- 12"	20	20	18	310	245	300	80	71	250	300	78
F2- 14"	20	20	20	365	280	330	90	71	290	355	95
F2- 16"	20	20	24	410	300	350	85	71	340	400	125
F2- 18"	40	40	28	480	355	485	155	85	400	470	155
F2- 20"	50	50	32	525	380	510	135	80	445	515	230

Double sheaved Blocks B2 and F2

Block Code	SWL Ton	Load Test	Load on headfittings Ton	Wire diameter mm	Weight Kg
B2 - 44	4	8	4	12	7,5
B2 - 64	4	8	4	10	21
B2 - 66	6	12	6	10	21
B2 - 68	8	16	8	10	21
F2 - 94	4	8	4	14	40
F2 - 96	6	12	6	14	40
F2 - 98	8	16	8	14	40
F2 - 910	10	20	10	14	40
F2 - 912	12	24	12	14	40
F2 - 1210	10	20	10	18	78
F2 - 1212	12	24	12	18	78
F2 - 1216	16	32	16	18	78
F2 - 1220	20	40	20	18	78
F2 - 1412	12	24	12	20	95
F2 - 1416	16	32	16	20	95
F2 - 1420	20	40	20	20	95
F2 - 1612	12	24	12	24	125
F2 - 1616	16	32	16	24	125
F2 - 1620	20	40	20	24	125
F2 - 1625	25	50	25	26	150
F2 - 1632	32	60	32	26	155
F2 - 1640	40	70	40	26	160
F2 - 1825	25	50	25	28	155
F2 - 1832	32	60	32	28	155
F2 - 1840	40	70	40	28	155
F2 - 2025	25	50	25	32	215
F2 - 2032	32	60	32	32	215
F2 - 2040	40	70	40	32	215
F2 - 2050	50	85	50	32	215

Lower Cargo Block with Hook

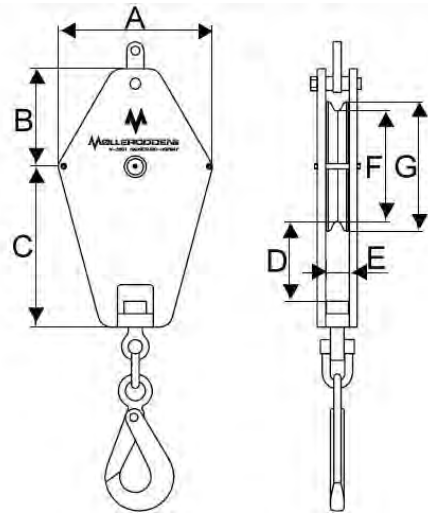
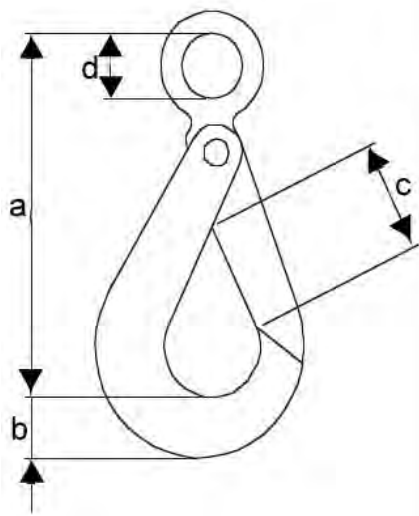

Block Code	SW L	Load Test	Load on headfitting	Wire dm	W.	Block dimensions						Hook dimensions on			
------------	------	-----------	---------------------	---------	----	------------------	--	--	--	--	--	--------------------	--	--	--

	Ton	Ton	Ton	Mm	Kg	A	B	C	D	E	F	G	a	b	c	d
F1 – 92/2L hv	2	12	6	14	45	320	180	350	180	46	190	230	254	50	68	50
F1 – 93/2L	3	12	6	14	45	320	180	350	180	46	190	230	254	50	68	50
F1 – 123/2L	3	12	6	18	95	390	245	375	175	71	250	300	254	50	68	50
F1 – 123/2I hv	3,4	20	10	18	95	390	245	375	175	71	250	300	254	50	68	50
F1 – 125/2L	5	20	10	18	95	390	245	375	175	71	250	300	320	62	84	70
F1 – 143/2L hv	3,4	20	10	20	135	445	280	480	255	71	290	355	320	62	84	70
F1 – 145/2L	5	20	10	20	135	445	280	480	255	71	290	355	320	62	84	70
F1 – 164/2L hv	4	24	12	24	150	490	300	500	255	71	340	400	320	62	84	70
F1 – 166/2L	6	24	12	24	150	490	300	500	255	71	340	400	320	62	84	70
F1 – 166/2L hv	6,7	40	20	26	195	490	320	550	275	85	335	400	400	81	120	90
F1 – 1610/2L	10	40	20	26	195	490	320	550	275	85	335	400	400	81	120	90
F1 – 186/2L hv	6,7	40	20	28	195	560	385	585	290	85	400	470	400	81	120	90
F1 – 1810/2L	10	40	20	28	230	560	355	585	290	85	400	470	400	81	120	90
F1 – 2010/2L	10	40	20	32	270	600	380	600	245	80	445	515	400	81	120	90

Snatch Block

K -42 to K -96:

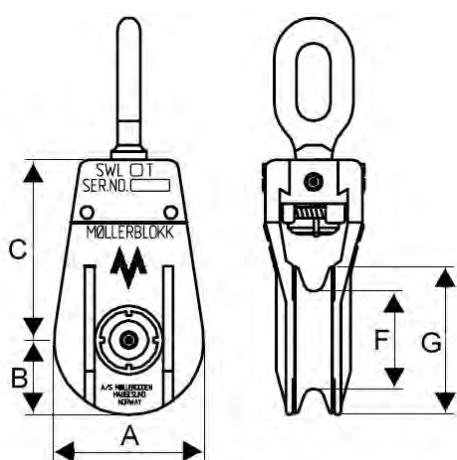

K -123 to K -2015:

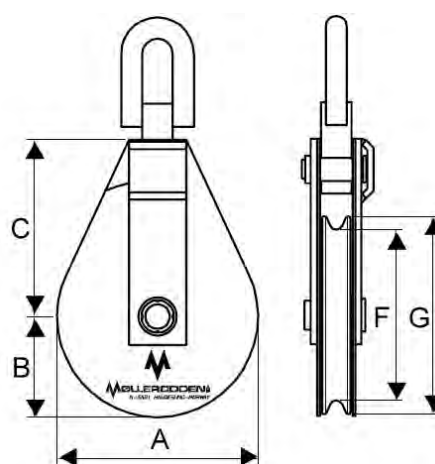

Block Code	SWL	Load test	Load on headfitting	Wire diameter	Weight	Block Dimensions				
	Ton	Ton	Ton	mm	Kg	A	B	C	ø F	ø G
K - 42	2	8	4	12	6	105	53	140	80	100
K - 42/5	2	8	4	12	6	105	53	140	80	100
K - 42 S	2	8	4	12	6	105	53	140	80	100
K - 62	2	8	4	20	12	155	77	185	100	150
K - 63	3	12	6	20	12	155	77	185	100	150
K - 64	4	16	8	20	12	155	77	185	100	150
K - 64/5	4	16	8	20	15	155	77	185	100	150
K - 64/S	4	16	8	20	15	155	77	185	100	150
TK - 64	4	16	8	20	16	155	77	185	100	150
K - 92	2	8	4	22	24	235	118	235	180	230
K - 93	3	12	6	22	24	235	118	235	180	230
K - 95	5	20	10	22	24	235	118	235	180	230
K - 96	6	24	12	22	24	235	118	235	180	230
K - 123	3	12	6	18	38	320	160	290	250	300

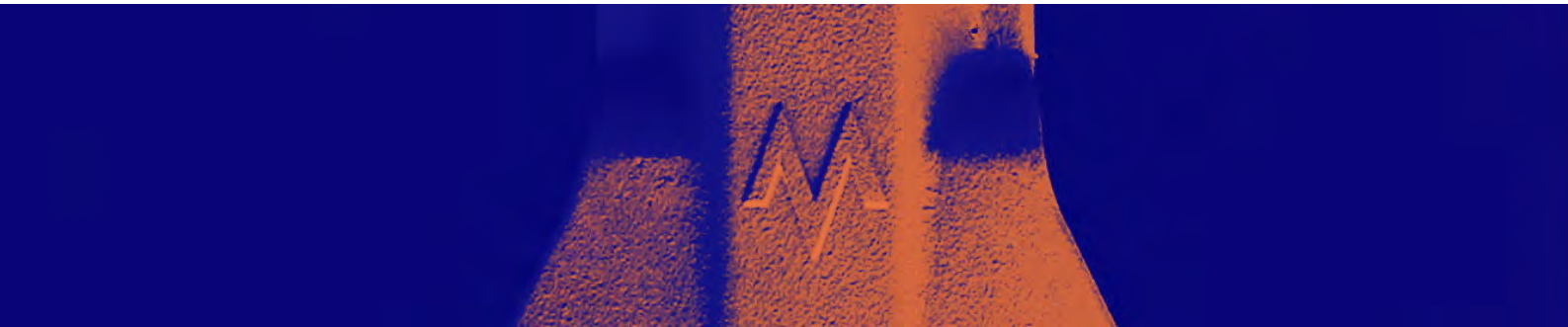

Snatch Block

Block Code	SWL	Load test	Load on headfitting	Wire diameter	Weight	Block Dimensions				
K - 125	5	20	10	18	38	320	160	290	250	300
K - 145	5	20	10	20	47	380	190	320	290	355
K - 146	6	24	12	20	47	380	190	320	290	355
K - 165	5	20	10	24	55	420	210	350	340	400
K - 168	8	32	16	26	100	420	210	410	335	400
K - 1610	10	40	20	26	100	420	210	410	335	400
K - 2015	15	55	30	32	165	560	265	510	445	515

Trawl Block

Trawl Block with Hinge:

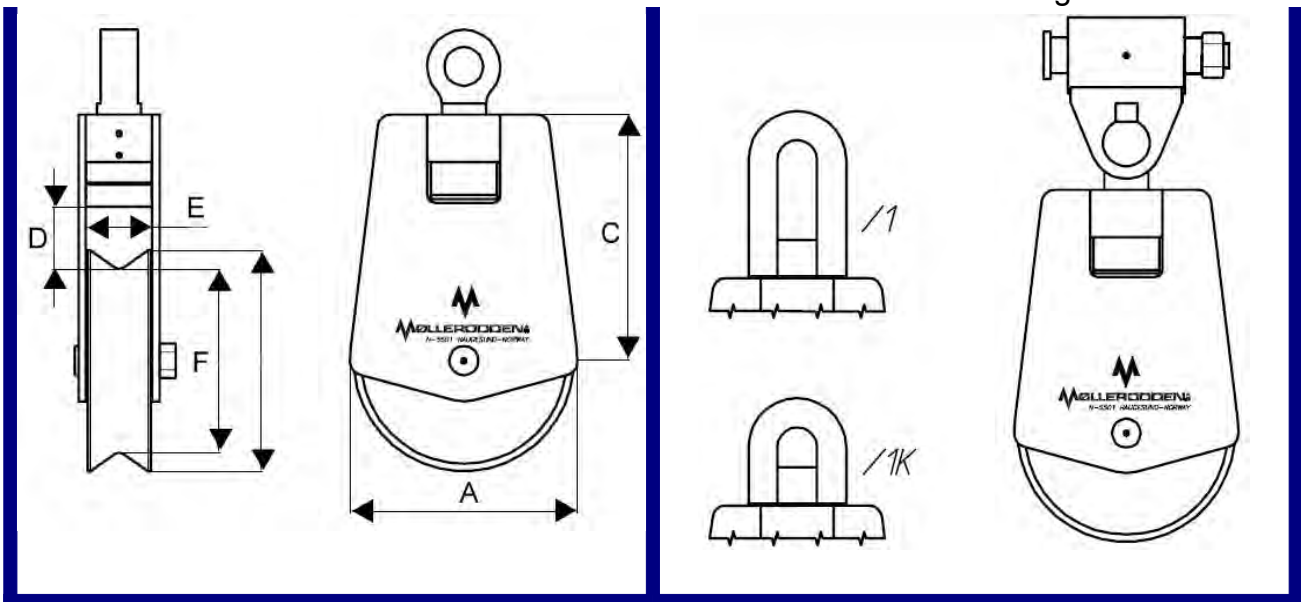

Block Code	Test Load	SWL Ton	Max Load on headfitting	A	C	D	E	F	G	Weight Kg
T 155-4	16	4	8	155	158	50	80	100	150	16
T 170-4	16	4	8	175	250	100	100	125	170	18

Trawl Block

Block Code	Test Load	SWL Ton	Max Load on headfitting	A	C	D	E	F	G	Weight Kg
T 255-4	16	4	8	270	335	170	124	190	255	50
T 300-5	20	5	10	320	355	165	140	220	300	80
TR 300-5	20	5	10	320	335	140	140	220	300	80
T 300-10	40	10	20	320	355	130	140	220	300	90
TR 300-10	40	10	20	320	355	110	140	220	300	90
T400-6	24	6	12	430	500	270	180	300	400	180
TR 400-6	24	6	12	430	500	180	180	300	400	180
T 400-12,5	50	12,5	25	430	500	200	180	300	400	180
TR 400-12,5	50	12,5	25	430	500	180	180	300	400	180
TR 400-30	95	30	60	430	550	180	180	300	400	200
T 500-12,5	50	12,5	25	520	550	220	180	300	500	260
TR 500-12.5	50	12,5	25	520	550	180	180	300	500	270
T 500-30	95	30	60	520	600	180	180	300	500	270
TR 500-30	95	30	60	520	600	170	180	300	500	290
TR 600-30	95	30	60	620	650	170	180	500	600	340
TR 600-30	95	30	60	620	690	240	240	460	600	450
TR 600-50	145	50	100	620	780	180	180	500	600	550
TR 600-50	145	50	100	620	830	240	240	460	600	750
TR 700-30	95	30	60	720	740	240	240	560	700	550
TR 700-50	145	50	100	720	880	270	240	560	700	800
TR 800-30	95	30	60	820	790	240	240	660	800	660
TR 800-50	145	50	100	820	930	270	240	660	800	950
TR 800-60	165	60	120	820	930	240	240	660	800	1000
TR 1000-50	145	50	100	1020	1130	270	240	860	1000	1200
TR 1000-60	165	600	120	1020	1030	240	240	860	1000	1250
TR 1200-100	266	100	200	1200	1180	240	240	1060	1200	2300

Standard Wire-sheaves for Møllerblokk

Figure No. 1:

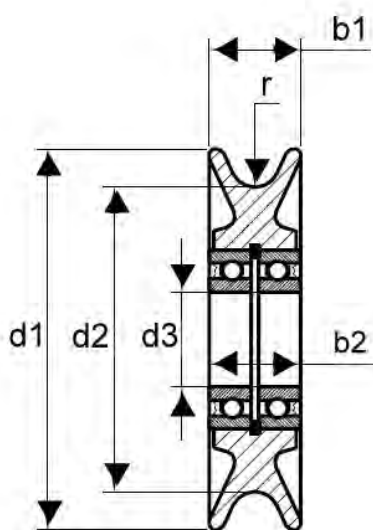

Figure No. 2:

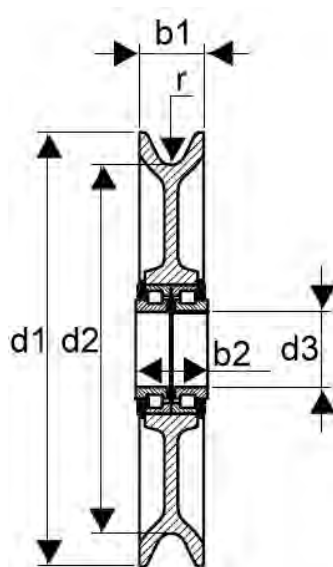
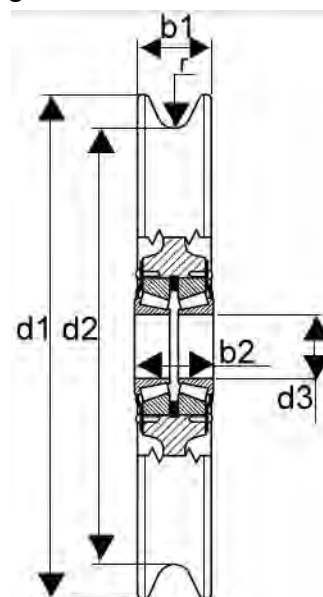
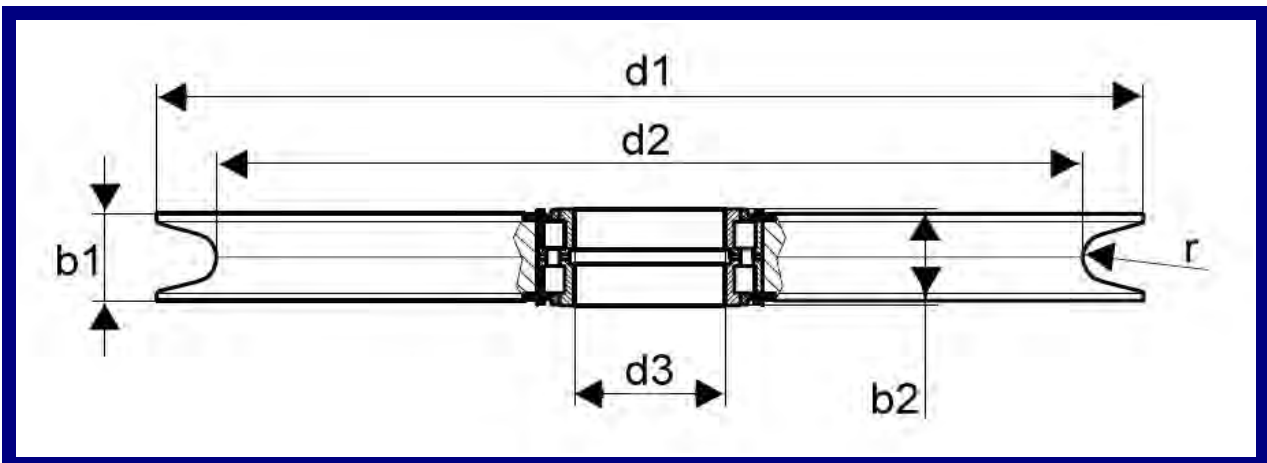

Figure No. 3:



Dy"	Drawing no.	Fig. no.	Max load on bearing	Wire diameter mm	d1	d2	d3	b1	b2	r	Weight Kg
4"	04100-03	1	2	12 (9 - 16)	100	80	25	24	26	6,3	1,2
4"	04150-03	2	6	12	100	80	25	24	30	6,3	1,2
6"	06100-03	1	6	10	155	130	40	33	39	5,3	2,5
6"	06150-03	2	10	20	150	100	40	40	38	10,5	2,2
9"	09101-03	2	10	14	230	195	40	34	38	7,5	5
9"	09150-03	2	18	22	230	180	55	40	46	11,5	5
9"	24300-03	3	12	14	230	190	30	41	46	7,5	5,5
9"	24712-03	3	28	24	230	175	40	64	70,5	12,7	8,5
12"	12101-03	3	28	18	300	250	40	64	70,5	9,5	10,5
14"	14101-03	3	28	20	355	290	40	64	70,5	10,5	15,5
16"	16101-03	3	28	24	400	340	40	64	70,5	12,7	18
16"	24600-03	3	36	26	400	335	50	75	84,5	14	24,5
18"	24800-03	3	40	28	470	400	50	78	84,5	15	36
20"	20100-03	3	44	32	515	445	65	75	80	17	41

Wire-sheaves in other dimensions



Drawing no.	Load on bearing Ton	Wire diameter mm	d1	d2	d3	b1	b2	Weight Kg
A4-2587	10	32	150	120	40	36	38	2
SK-3225	10	19	170	125	40	95	98	10
A3-0185	4	10	185	160	45	31	34,5	3
A3-0195	15	13	330	280	50	36	40	10
A4-3403	18	15	335	280	55	42	46	10
A3-0085	-	18	405	345	70	50	54	20
A4-2468	27	19	420	360	70	50	54	18
A4-3588	27	60	440	300	70	100	54	59
A4-2542	34	18	460	400	80	54	60	25
A3-0108	-	32	550	486	100	80	67	40
SK-2679	53	25	550	470	85	52	60	40
A4-0789	52	22	570	500	-	59	-	55
A4-1964	65	24	575	500	110	70	80	-
A4-2559	34	20	600	535	80	60	54	40
A4-2551	34	24	600	535	80	54	60	38
SK-3389	-	-	610	550	-	70	-	80
SK-2562	55	30	656	576	100	60	67	70
A4-0410	65	30	700	600	110	72	80	90
SK-2470	50	34	750	670	100	70	125	80

Wire-sheaves in other dimensions

Drawing No.	Load on bearing Ton	Wire diameter mm	d1	d2	d3	b1	b2	Weight Kg
SK-2694 A	55	38	780	658	100	114	114	115
A3-0189	110	40	780	680	100	130	140	160
A3-0132	53	28	785	720	90	54	67	90
SK-2586	96	32 - 48	900	800	130	77	95	150
SK-3099-1	180	67	938	670	150	135	165	270
SK-3099	240	67	938	670	180	110	165	270
SK2951	51	36 - 38	970	865	80	80	90	290
SK-2854	210	56	1000	860	180	110	136	260
SK-2561	175	50 - 54	1070	940	170	100	122	270
SK-3353-01	96	28/34	1136	1040	130	92	95	215/170
SK-2178	265	57	1140	1000	200	140	150	250
SK-3098-1	180	67	1143	983	150	135	165	390
SK3098-2	240	67	1143	983	200	135	165	270
SK-3352	136	28/34	1136	1040	140	92	95	215
SK-2541	175	42 - 64	1280	1140	170	100	122	440
A4-0431	17,5	45	1320	1210	55	80	92	315
SK-2901*	-	43	1320	1200	282	105	108	315
A2-0110	210	40 - 66	1352	1202	180	135	136	635
SK-2432*	-	35	1525	1475	470	95	82	614
A4-2221	470	84	1760	1561	260	160	190	1000
A3-0112	38	40	2080	1958	110	100	145	900
A3-0114	38	40	2080	1958	200	100	220	900
SK2806	700	127	2100	1820	450	220	260	1950
SK-2910	-	38	2150	2030	-	105	108	1030

Material SJK 500 NS 11350.

Material certificate to be specified.

Without bearing

Multipurpose Wire-sheaves

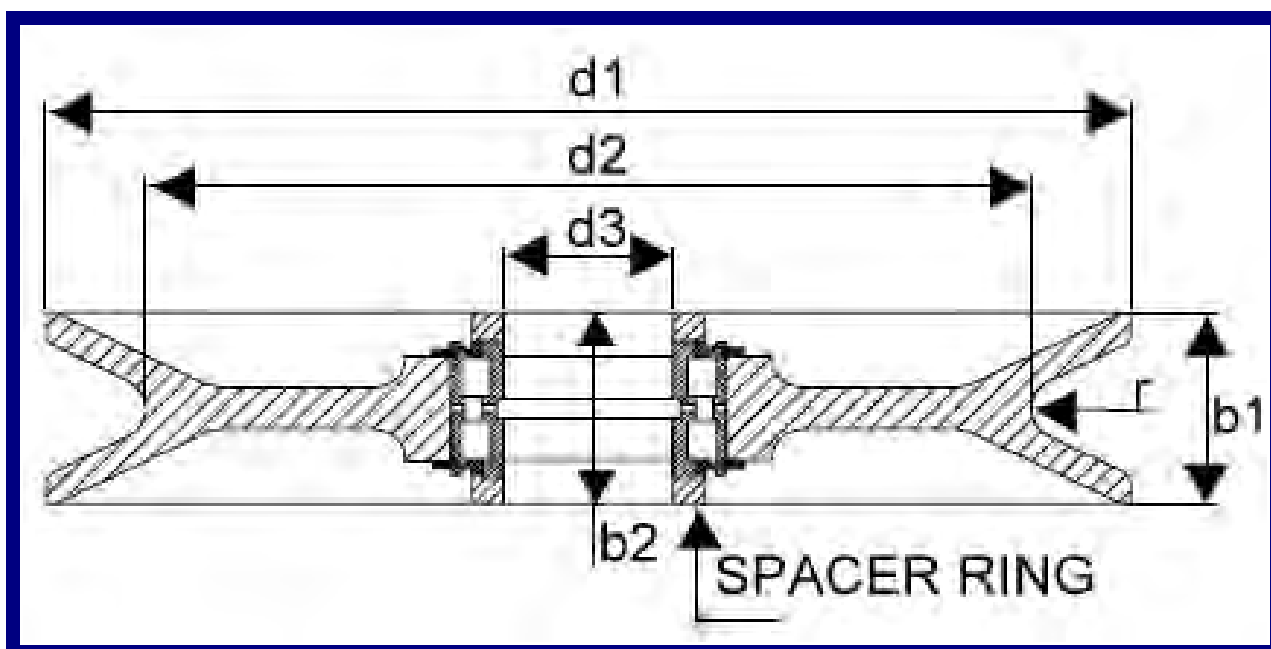

Dy"	Drawing no.	SWL Ton	Wire diameter mm	d1	d2	d3	b1	b2	r	Weight Kg
* 9"	SK 1500	11	9 - 16	230	195	40	34	38	7,5	5
9"	SK 1501	18		230	175	55	64	68	12,7	8,5
12"	SK 1502	18	12 - 18	300	250	55	64	68	9,5	10,5
14"	SK 1503	18	18 - 20	355	290	55	64	68	10,5	15,5
16"	SK 1504	18	16 - 26	400	340	55	64	68	12,7	18
16"	SK 1505	35	26	400	335	85	66	70	14	24,5
18"	SK 1506	35	26 - 31	470	400	85	66	70	15	36
20"	SK 1507	51	26 - 36	515	445	90	75	80	17	41

*SK 1500 are supplied without spacer rings.

Materialcertificate DIN 50049 2.3 upon request on both **Standard Wire-sheaves** and **Multipurpose Wire-sheaves**.

Sound Cable Block

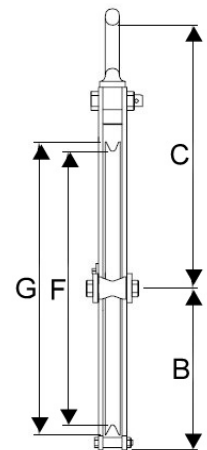
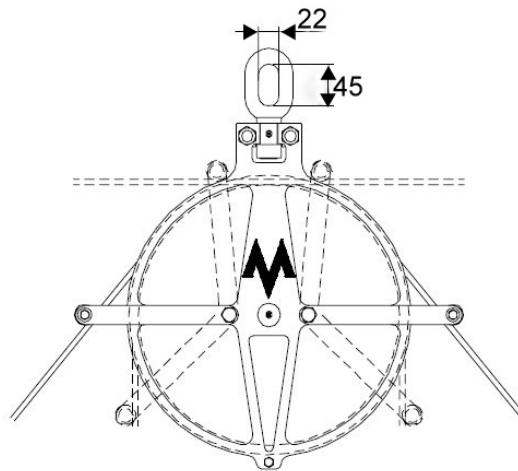

Block Code	SWL	Test Load	Cable diameter	Block Dimension			
	Ton	Ton	mm	B	C	F	G
SB 410-D6	5	10	6	245	485	410	450
SB 410-D8	5	10	8	245	485	410	450
SB 440-D6	5	10	6	260	500	440	480
SB 440-D8	5	10	8	260	500	440	480
SB 410-D11	5	10	11	245	485	410	450
SB 440-D11	5	10	11	260	500	440	480
SB 410-D12	5	10	12	245	485	410	450
SB 440-D12	5	10	12	260	500	440	480
SB 560-D10	5	10	10	330	538	560	600
SB 560-D11	5	10	11	330	538	560	600
SB 560-D12	5	10	12	330	538	560	600



Manrider Block

A4-3457-10

SWL: 1Te, 2Te in swivel oval eye

For $\varnothing 10-14\text{m}$ wire

F.O.S 10:1

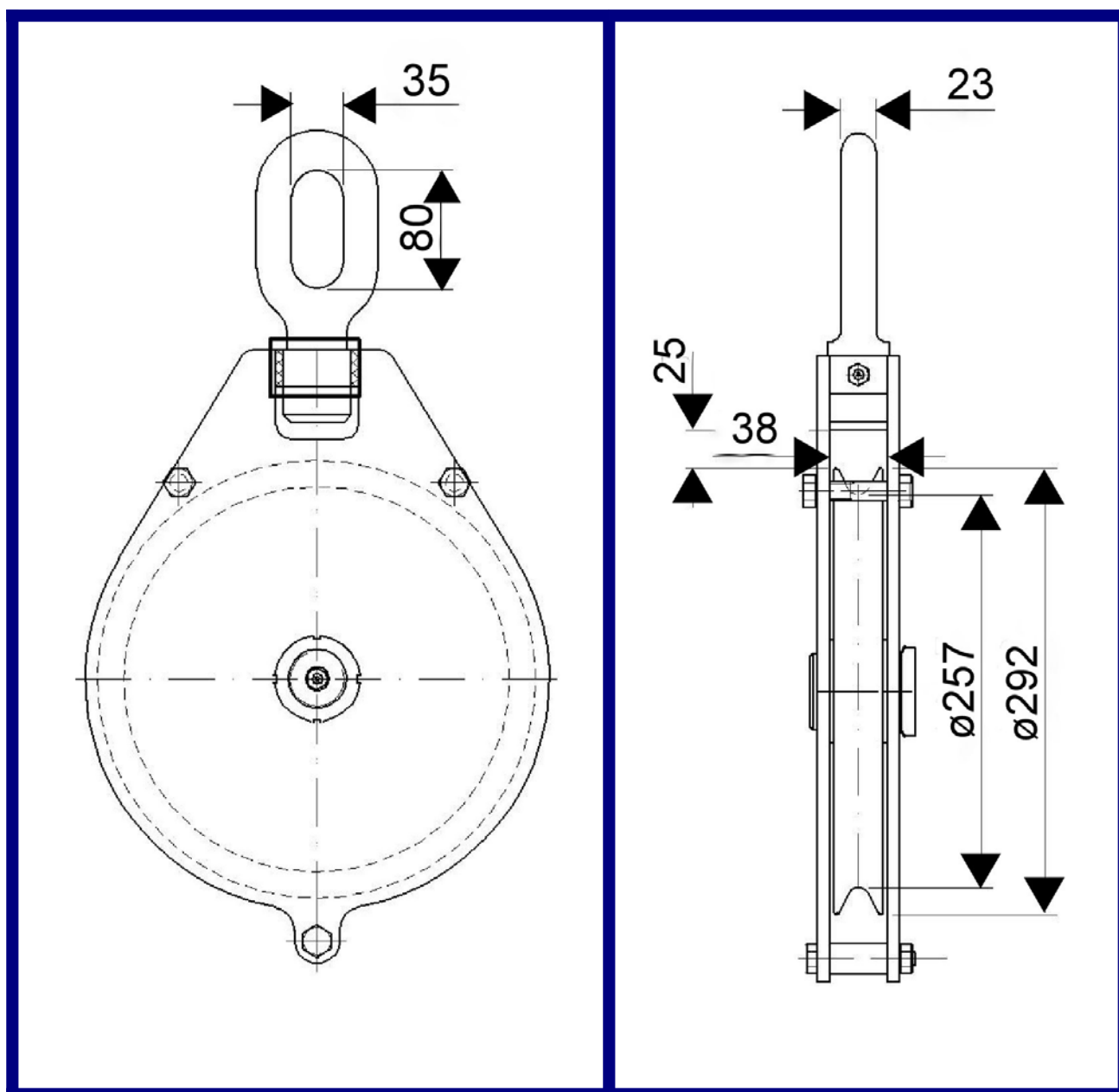

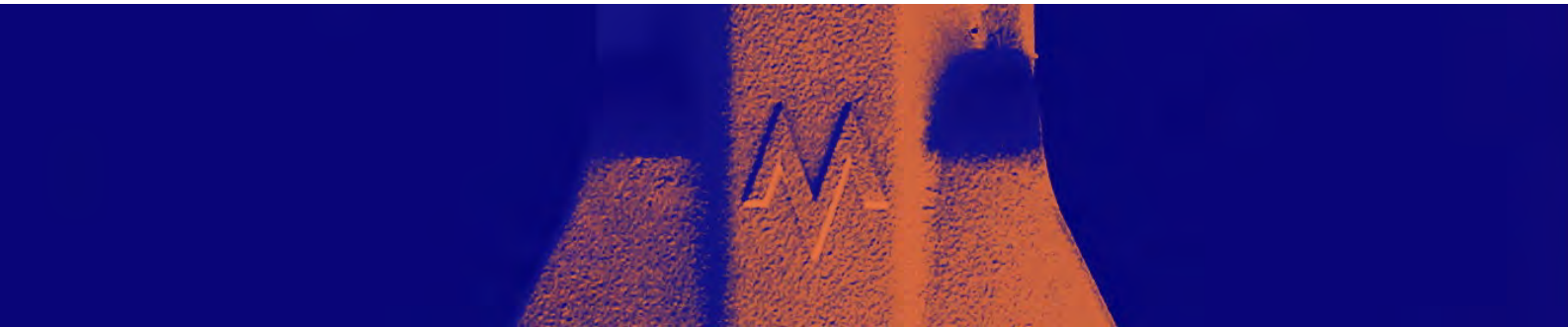

The 30000-series

Model 30101-13:

Single sheaved Cargo Block

WLL: 3 tons in wire

WLL: 6 tons in hook for \varnothing 13mm wire

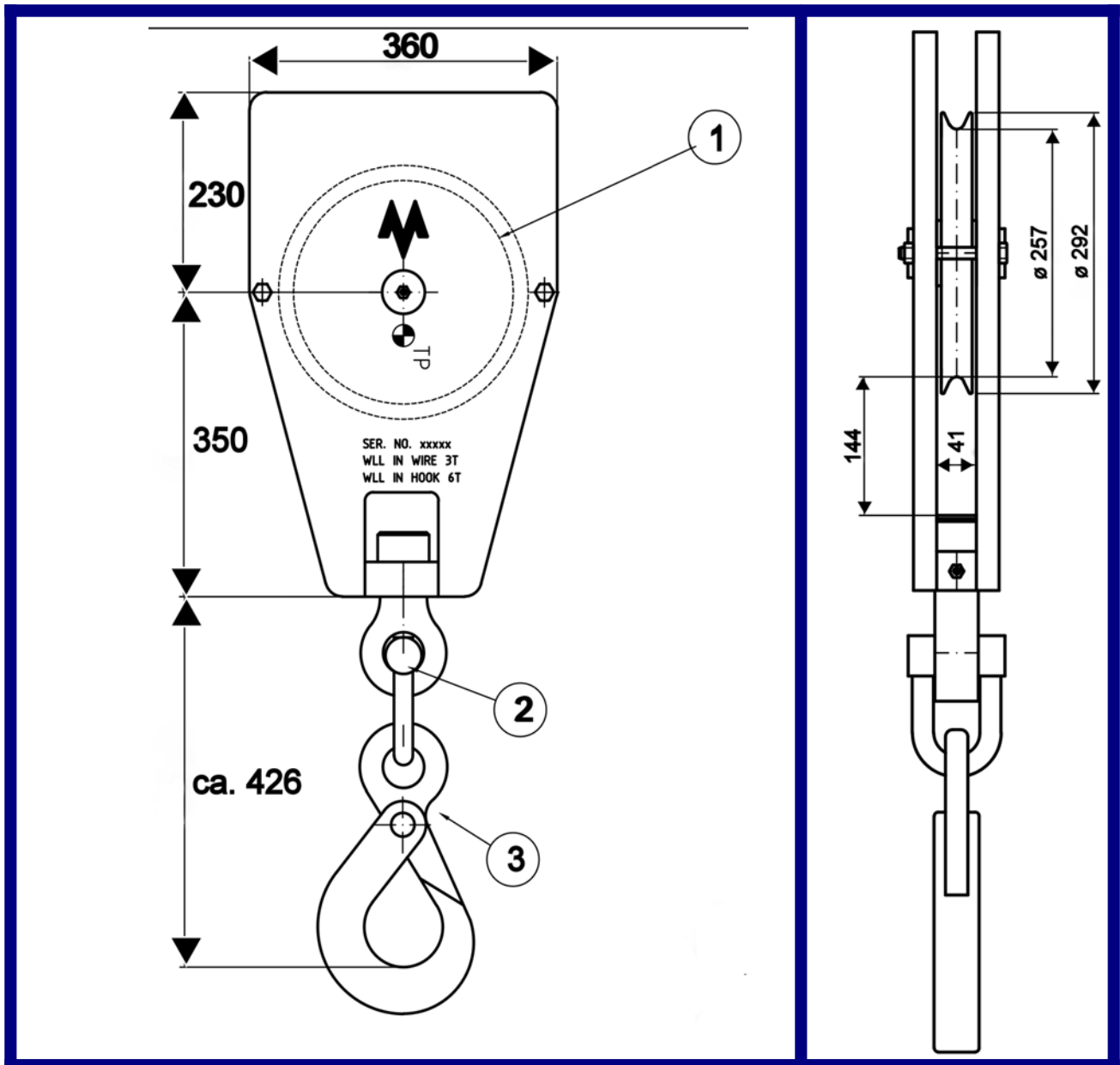

Model 32103:

Single sheaved block, with chain and hook
SWL: 6 tons, SWL: 12 tons in hook \varnothing 18mm wire

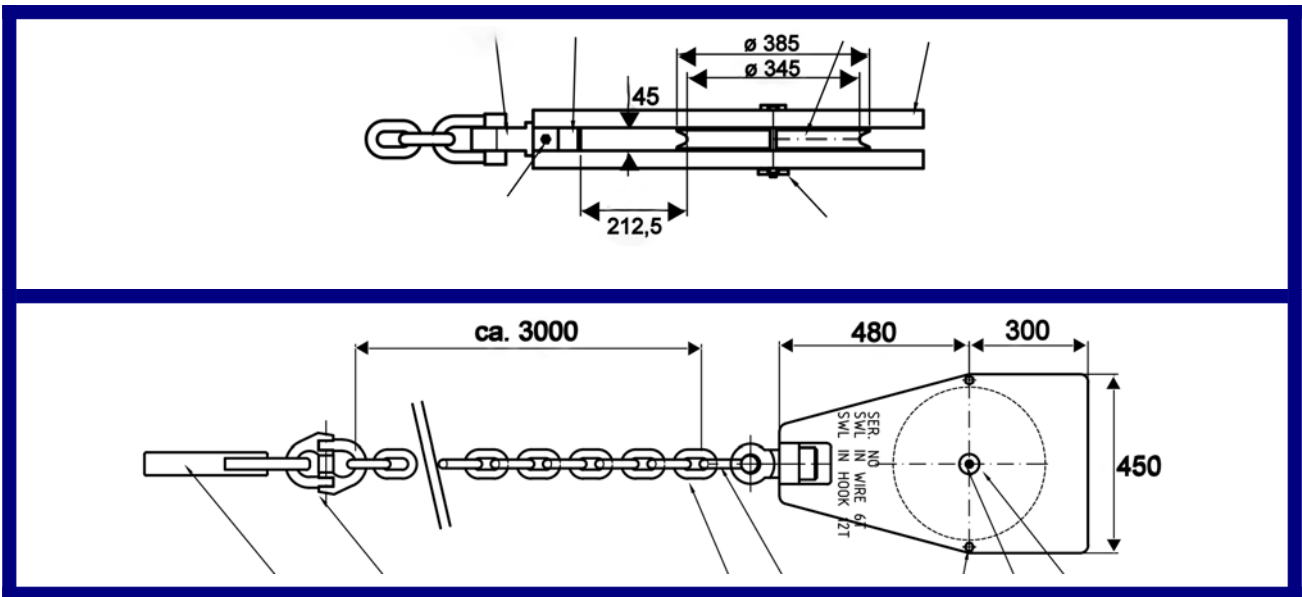

Model 33223

Double sheaved block with chain and hook. For \varnothing 20mm wire
SWL: 25 tons, 25 tons in single hook.

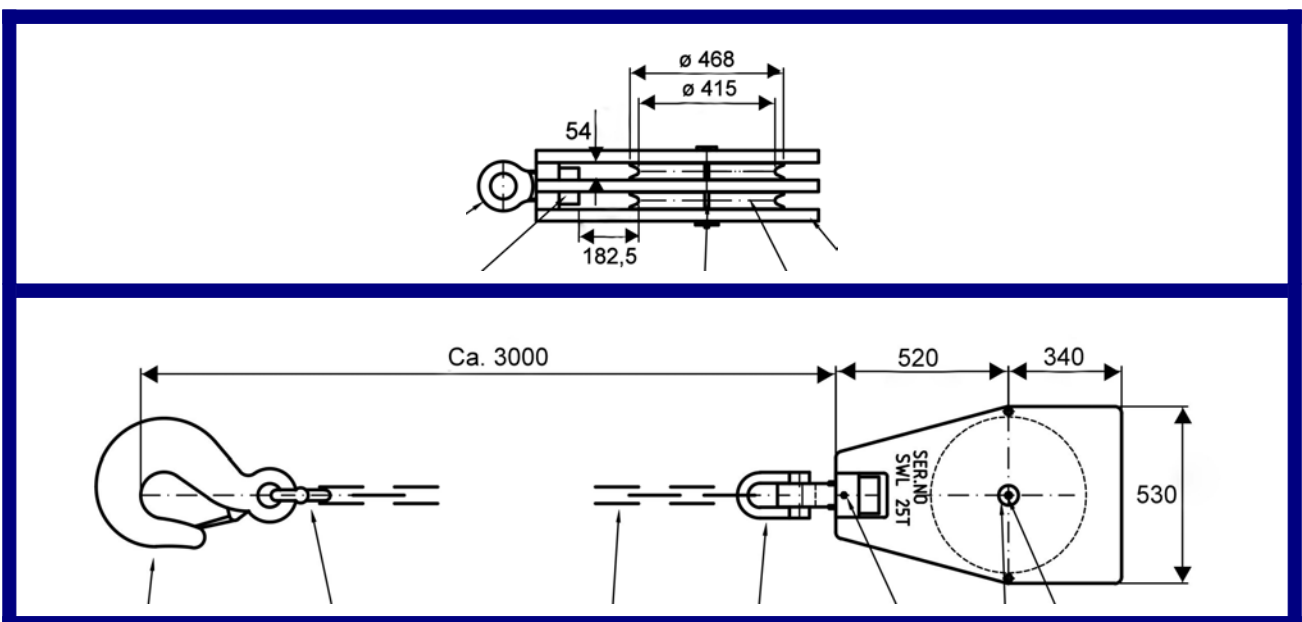

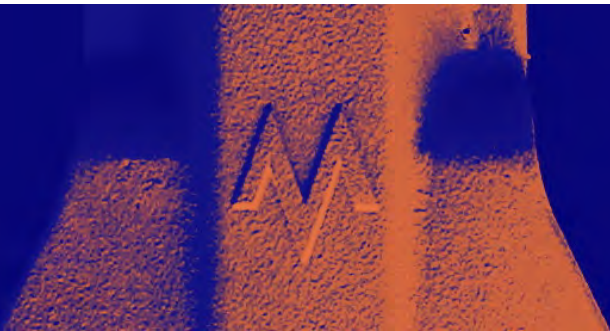

Model 34142

Single sheaved block with becket

SWL: 8,3 tons in wire

SWL: 25 tons in eye

ø 22 mm wire

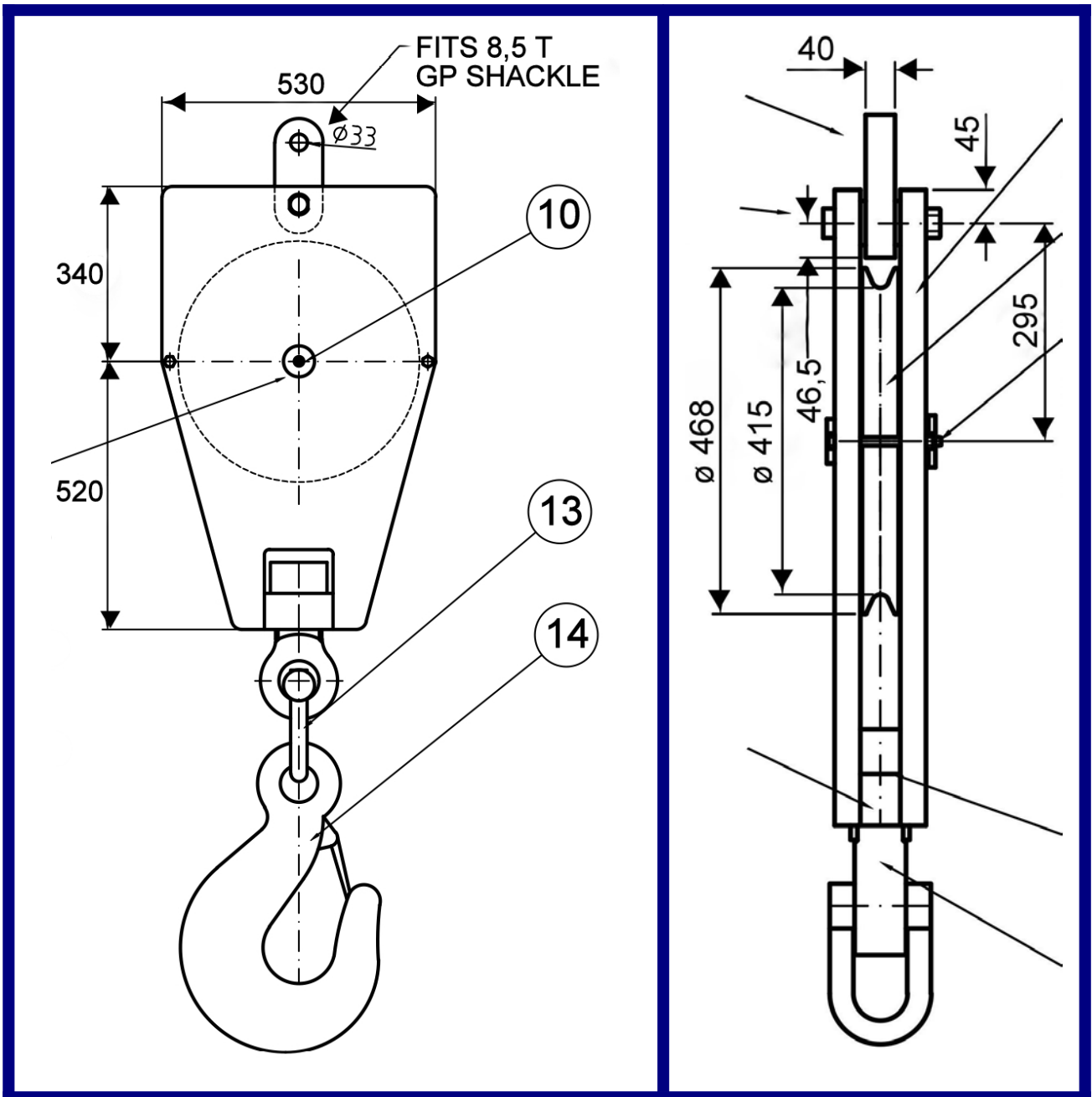

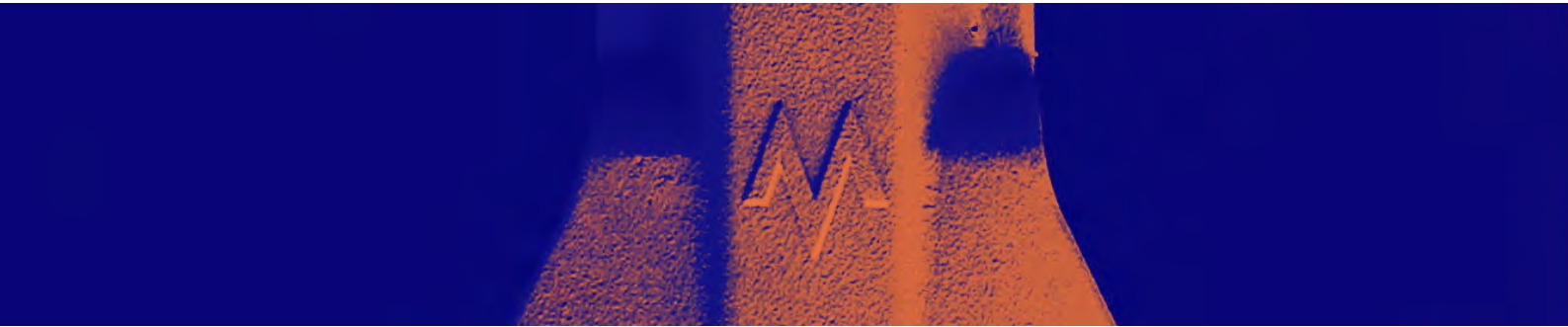

Model 35111

Single sheaved block

WLL: 10 tons

WLL: 20 tons in hook

For \varnothing 24 mm wire

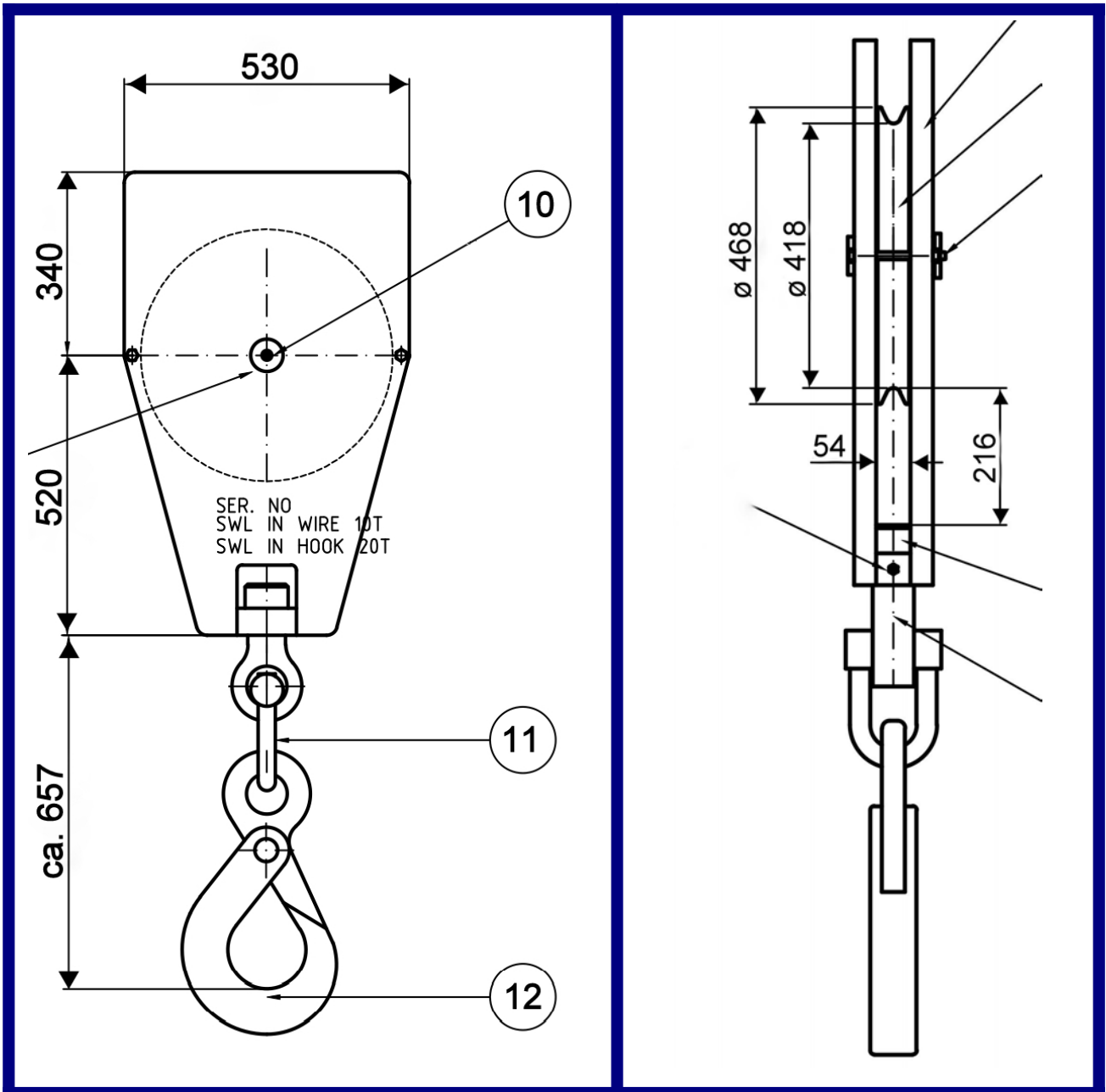

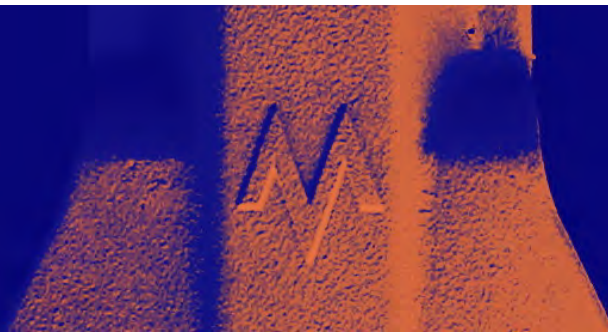

The 30000-series

Single sheaved

Drawing no	Wire Ø	SWL in wire	SWL in hook	Becket	Chain	Info
30000	10-12 mm	1,5 T	3 T	No	No	No hook
30001	10-12 mm			No	No	
30002	10-12 mm	1,5 T	3 T	No	No	
30003	10-12 mm	1,5 T	3 T	No	Yes	
30003	10-12 mm	1,5 T	3 T	No	3 m	
30010	10-12 mm	1,5 T	4,5 T	Yes	No	
30011	10-12 mm	1,5 T	4,5 T	Yes	No	
30012	10-12 mm	1,5 T	4,5 T	Yes	Yes	
30013	10-12 mm	1,5 T	4,5 T	Yes	3 m	
30020	10-13 mm	2 T	4 T	No	No	No hook
30021	10-13 mm	2 T	4 T	No	No	
30022	10-13 mm	2 T	4 T	No	Yes	
30023	10-13 mm	2 T	4 T	No	3 m	
30030	10-13 mm	2 T	6 T	Yes	No	
30031	10-13 mm	2 T	6 T	Yes	No	
30032	10-13 mm	2 T	6 T	Yes	Yes	
30033	10-13 mm	2 T	6 T	Yes	3 m	
30100	12-14 mm	3 T	6 T	No	No	No hook
30101	12-14 mm	3 T	6 T	No	No	
30102	12-14 mm	3 T	6 T	No	Yes	
30103	12-14 mm	3 T	6 T	No	3 m	
30110	12-14 mm	3 T	9 T	Yes	No	
30111	12-14 mm	3 T	9 T	Yes	No	
30112	12-14 mm	3 T	9 T	Yes	Yes	
30113	12-14 mm	3 T	9 T	Yes	3 m	
30120	12-14 mm	3 T	9 T			

The 30000-series

Single sheaved

Drawing no	Wire Ø	SWL in wire	SWL in hook	Becket	Chain	Info
31100	14-16 mm	4 T	8 T	No	No	No hook
31101	14-16 mm	4 T	8 T	No	No	
31102	14-16 mm	4 T	8 T	No	Yes	
31103	14-16 mm	4 T	8 T	No	3 m	
31110	14-16 mm	4 T	12 T	Yes	No	
31111	14-16 mm	4 T	12 T	Yes	No	
31112	14-16 mm	4 T	12 T	Yes	Yes	
31113	14-16 mm	4 T	12 T	Yes	3 m	
32100	18-20 mm	6 T	12 T	No	No	No hook
32101	18-20 mm	6 T	12 T	No	No	
32102	18-20 mm	6 T	12 T	No	Yes	
32103	18-20 mm	6 T	12 T	No	3 m	
32110	18-20 mm	6 T	18 T	Yes	No	
32111	18-20 mm	6 T	18 T	Yes	No	
32112	18-20 mm	6 T	18 T	Yes	Yes	
32113	18-20 mm	6 T	18 T	Yes	3 m	
33101	18-22 mm	5 T	10 T	No	No	
33110	18-22 mm	4 T	12 T	Yes	No	
33111	18-22 mm	4 T	12 T	Yes	No	
33112	18-22 mm	4 T	12 T	Yes	Yes	
33113	18-22 mm	4 T	12 T	Yes	3 m	
33130	18-22 mm	6,7 T	20 T	Yes	No	
33142	18-22 mm	8 T	24 T	Yes	No	

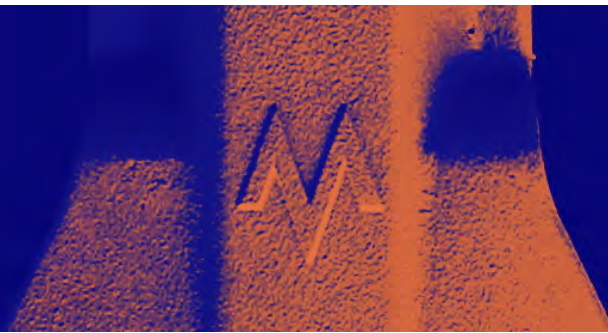

The 30000-series

Single sheaved

Drawing no	Wire Ø	SWL in wire	SWL in hook	Becket	Chain	Info
34110	20-24 mm	8,3 T	16, 6 T	No	No	
34111	20-24 mm	8,3 T	16, 6 T	No	No	
34113	20-24 mm	8,3 T	16, 6 T	No	2,4 m	
34120	20-24 mm	8,3 T	25 T	Yes	No	
34131	20-24 mm	8,3 T	25 T	Yes	No	
34142	20-24 mm	8,3 T	25 T	Yes	No	
35111	20-24 mm	10 T	20 T	No	No	

The 30000-series

Double sheaved

Drawing no	Wire Ø	SWL in wire	SWL in hook	Becket	Chain	Info
30200	12-14 mm		6 T	No	No	No hook
31200	14-16 mm		16 T	No	No	No hook
31201	14-16 mm		16 T	No	No	
31202	14-16 mm		16 T	No	Yes	
31203	14-16 mm		16 T	No	3 m	
32200	18-20 mm		20 T	No	No	No hook
32201	18-20 mm		20 T	No	No	
32202	18-20 mm		20 T	No	Yes	
32203	18-20 mm		20 T	No	3 m	
33220	18-22 mm		25 T	No	No	No hook
33223	18-22 mm		25 T	No	3 m	

Other Products

To show you the diversity of our product-line, we will show you some illustrations as examples to other products that we manufacture.

Model A3-0421

Block for x-tree crane

SWL: 20 tons

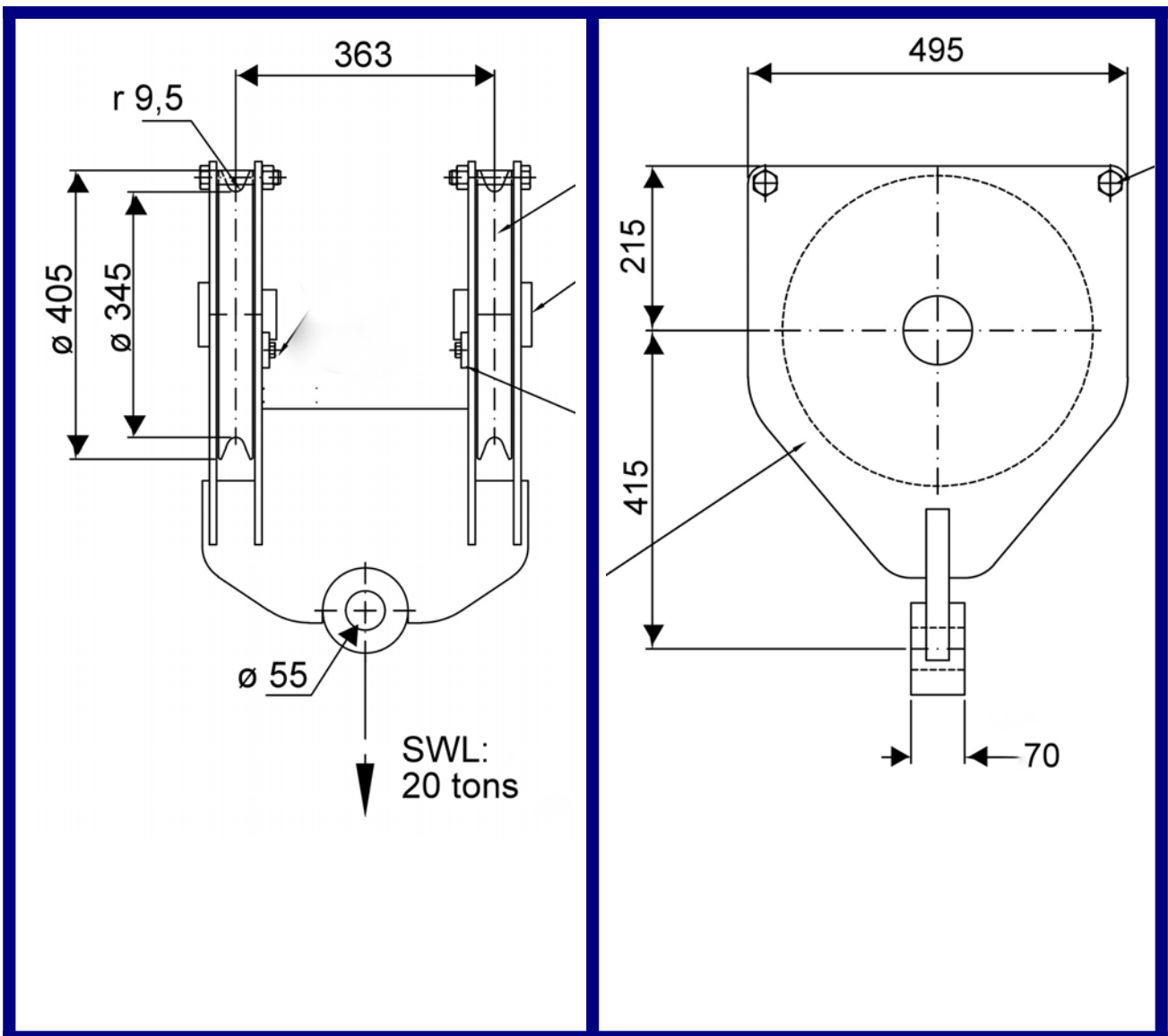

Model A3- 0396

Three sheaved cargo block

SWL: 60 tons

ø 22 wire

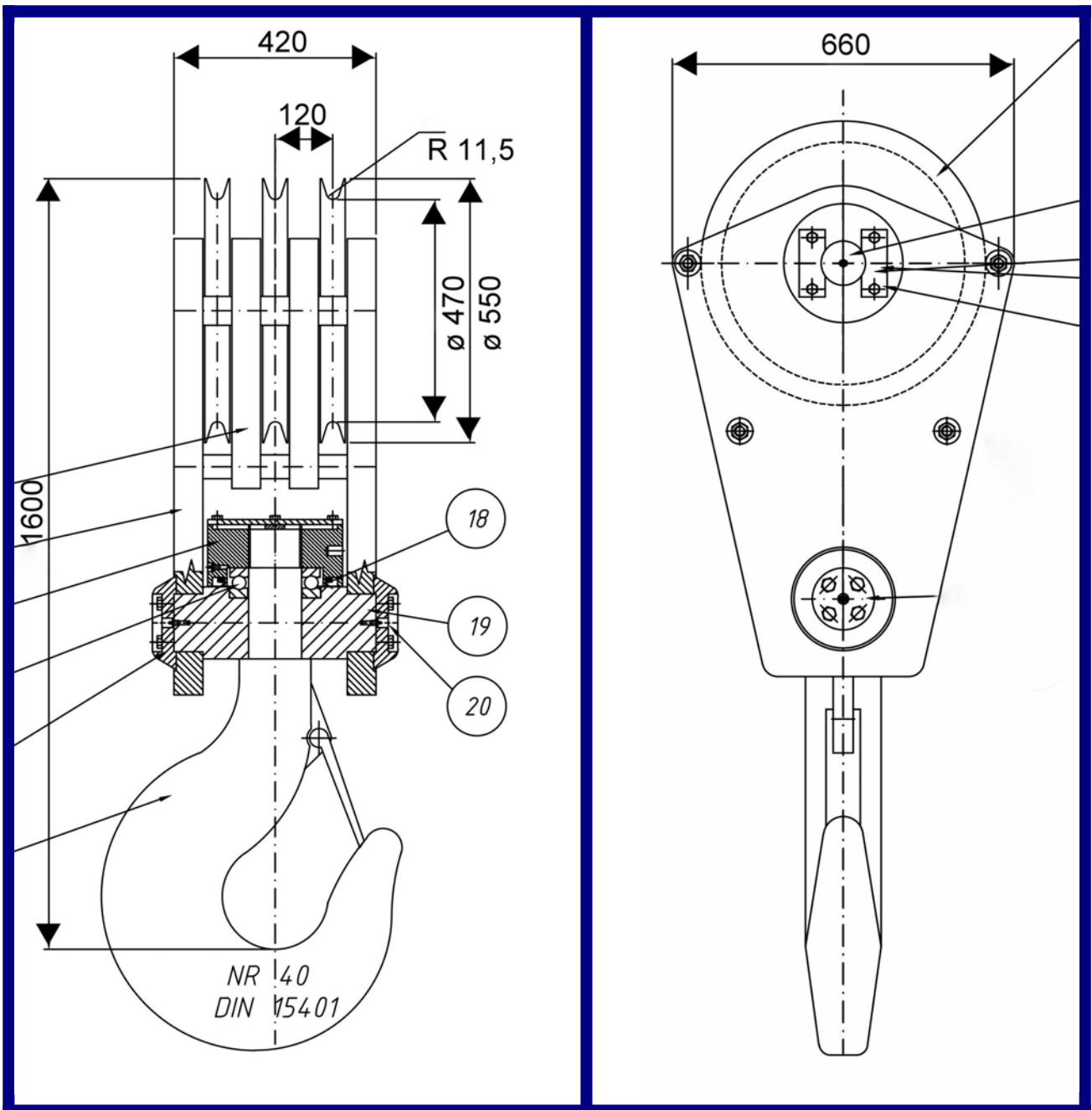

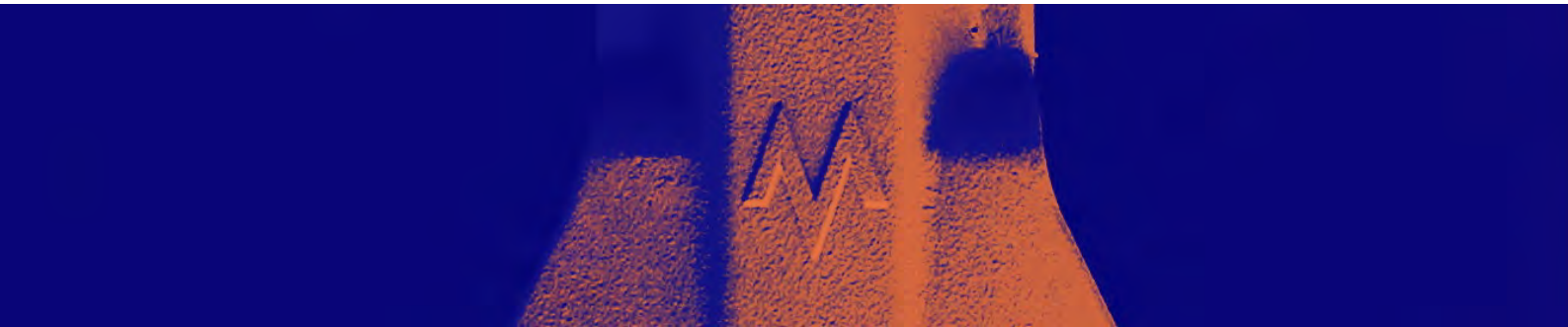

Model A3- 0397

Tandem-block

SWL: 14 tons

ø 22mm wire

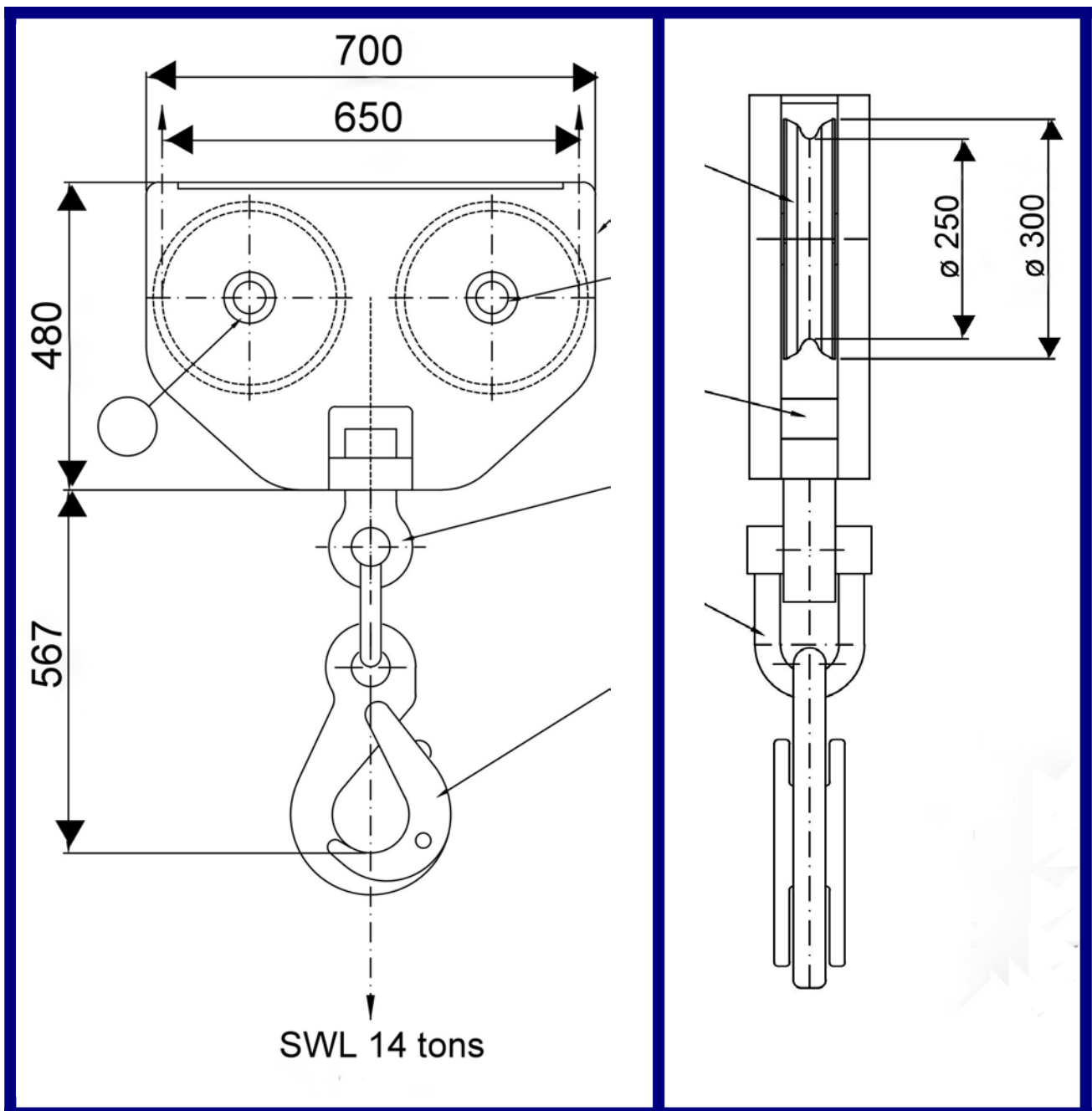

Model: A2- 0084 Rev F
 Alublock 105,
 WLL: 6000 Kp
 in oval eye

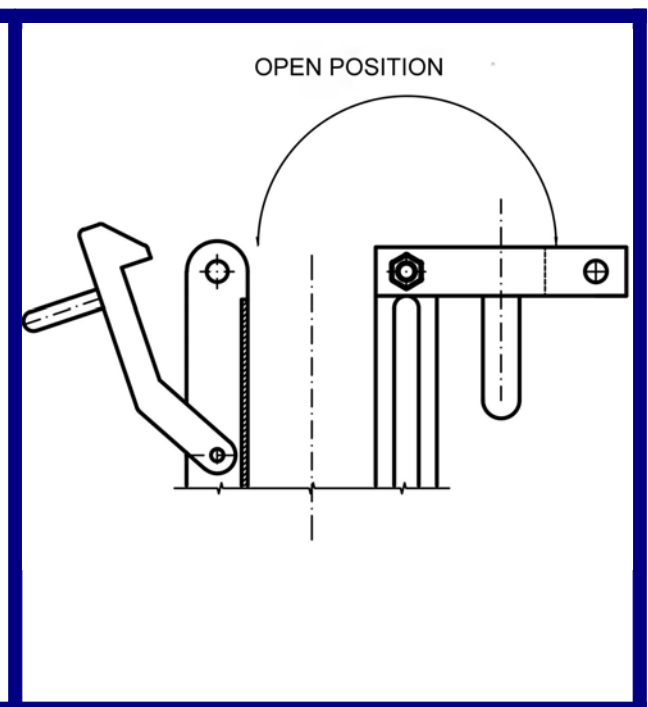
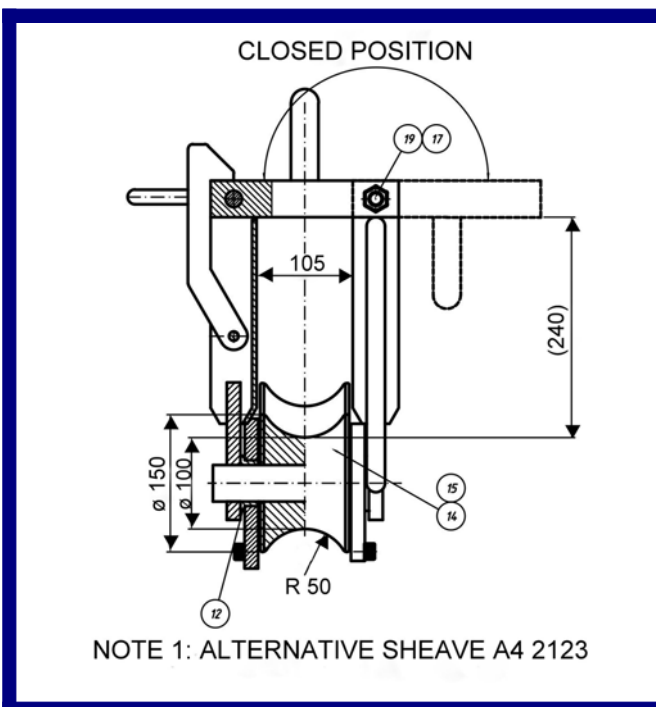
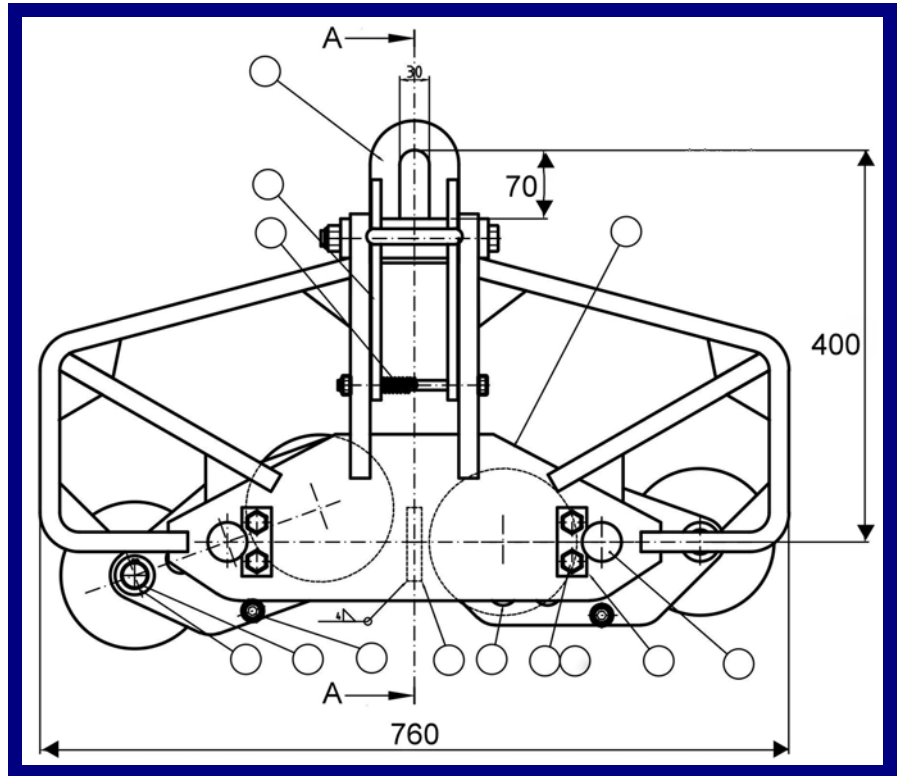

Model A3- 0478
Four-sheaved block
WLL/DL: 150 tons
For \varnothing 34 mm wire

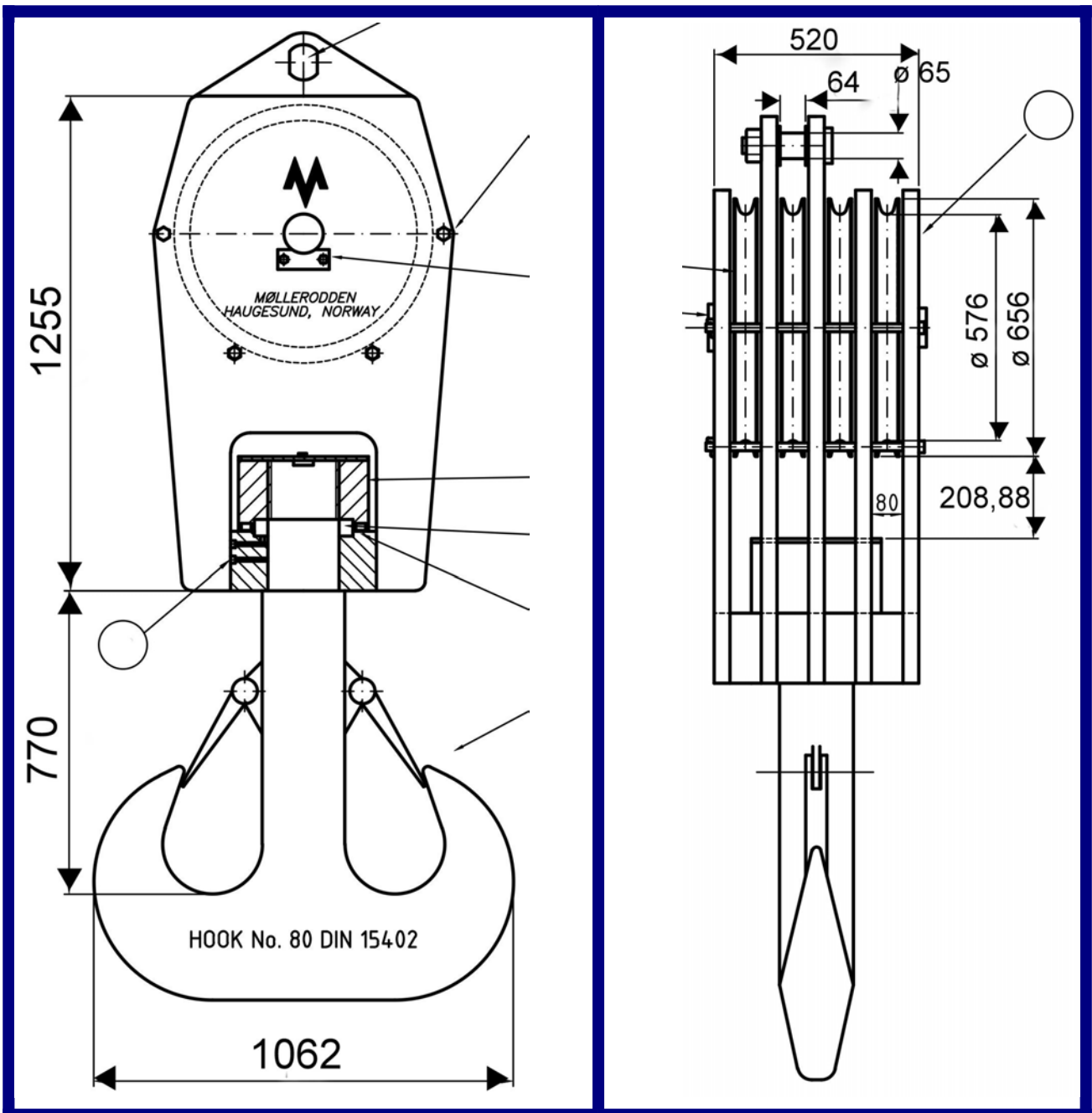

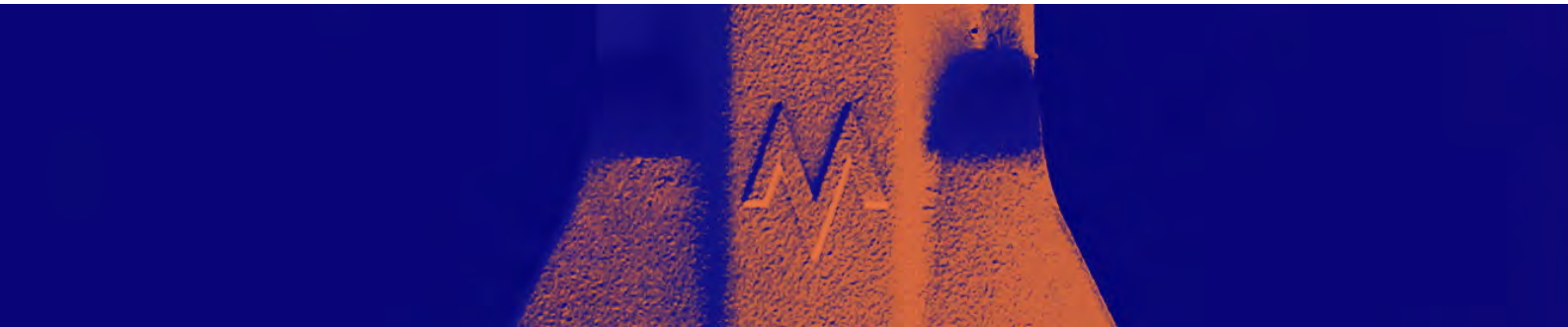

Model A3- 0577
Four-sheaved block
SWL: 75 tons

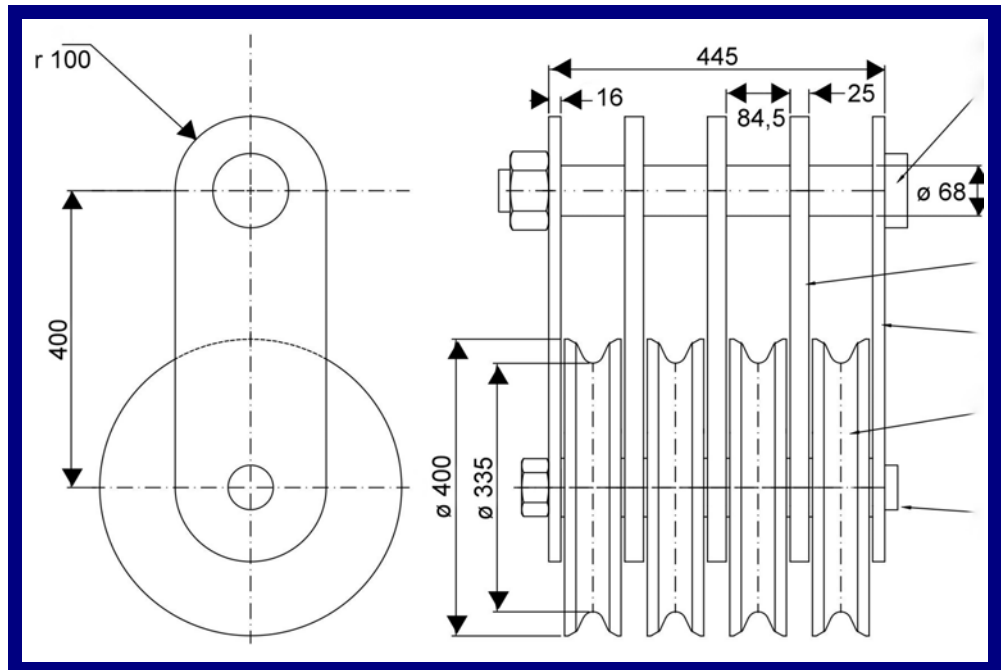

Model A3- 0555
Swivel, Designload: 50 tons

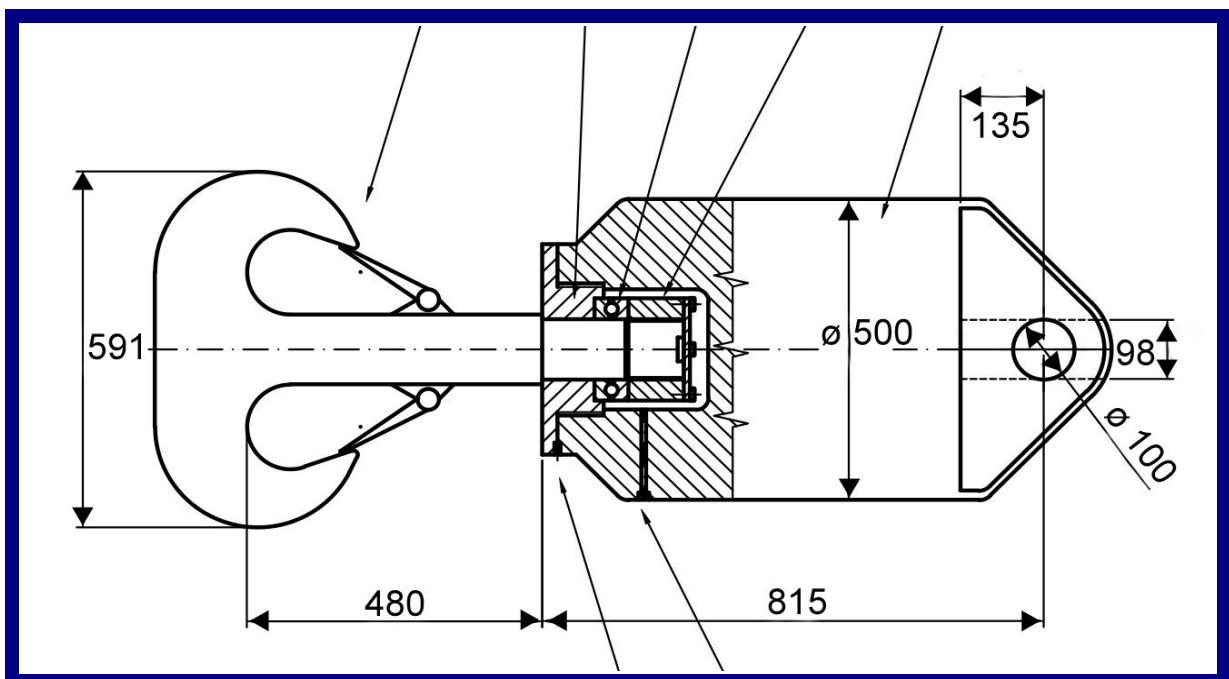

Model A3- 0587

Single sheaved block

WLL: 80 tons

DL in hook: 180 tons 2-fall, 90 tons 1-fall

Load test: 240 tons 2-fall, 130 tons 1-fall

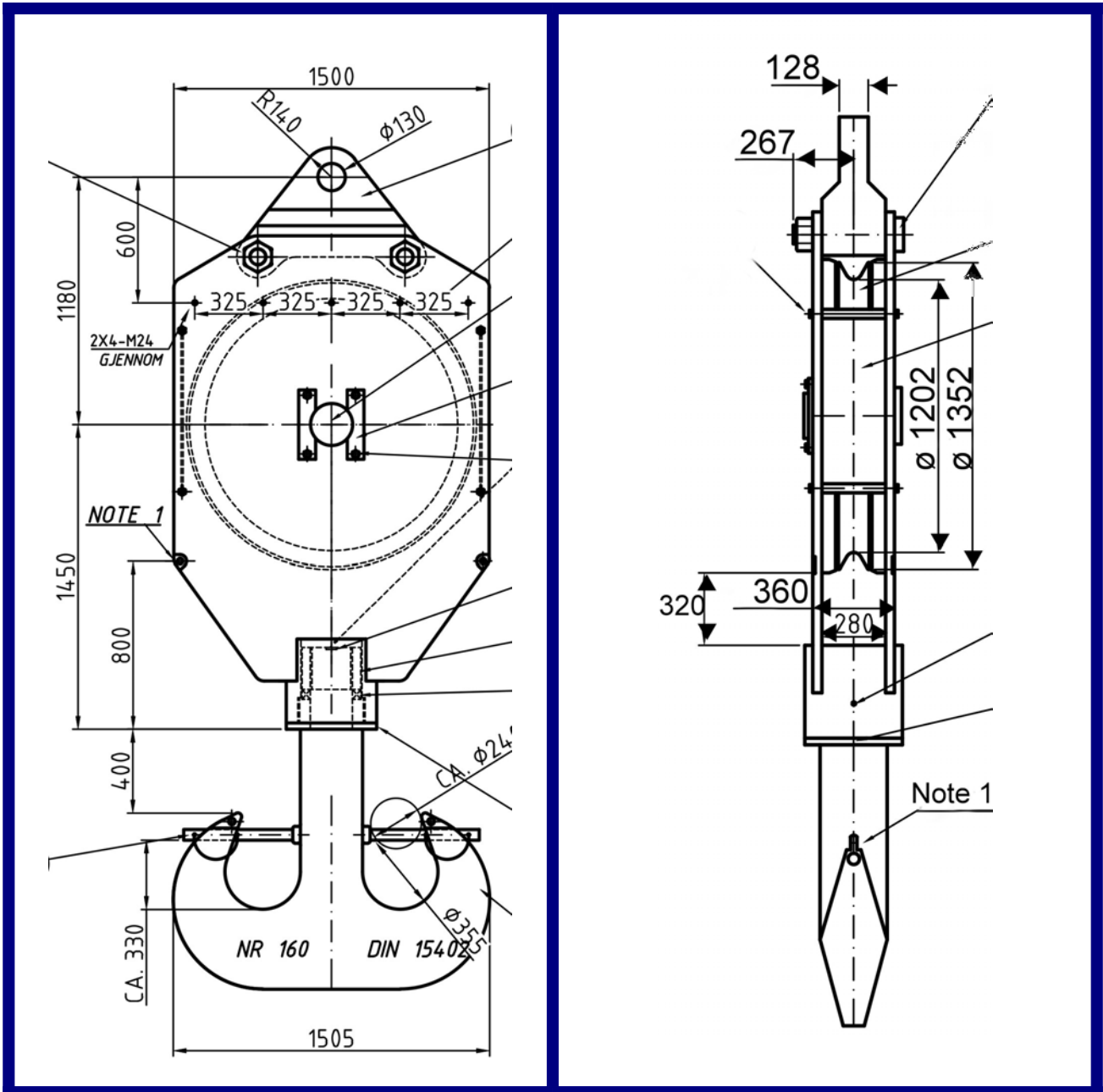

Model A3- 0771

Single sheaved Block

SWL: 80 tons

DL in hook: 180 tons

2-parts: 90 tons

1 part load test: 240 tons

2-parts: 130 tons

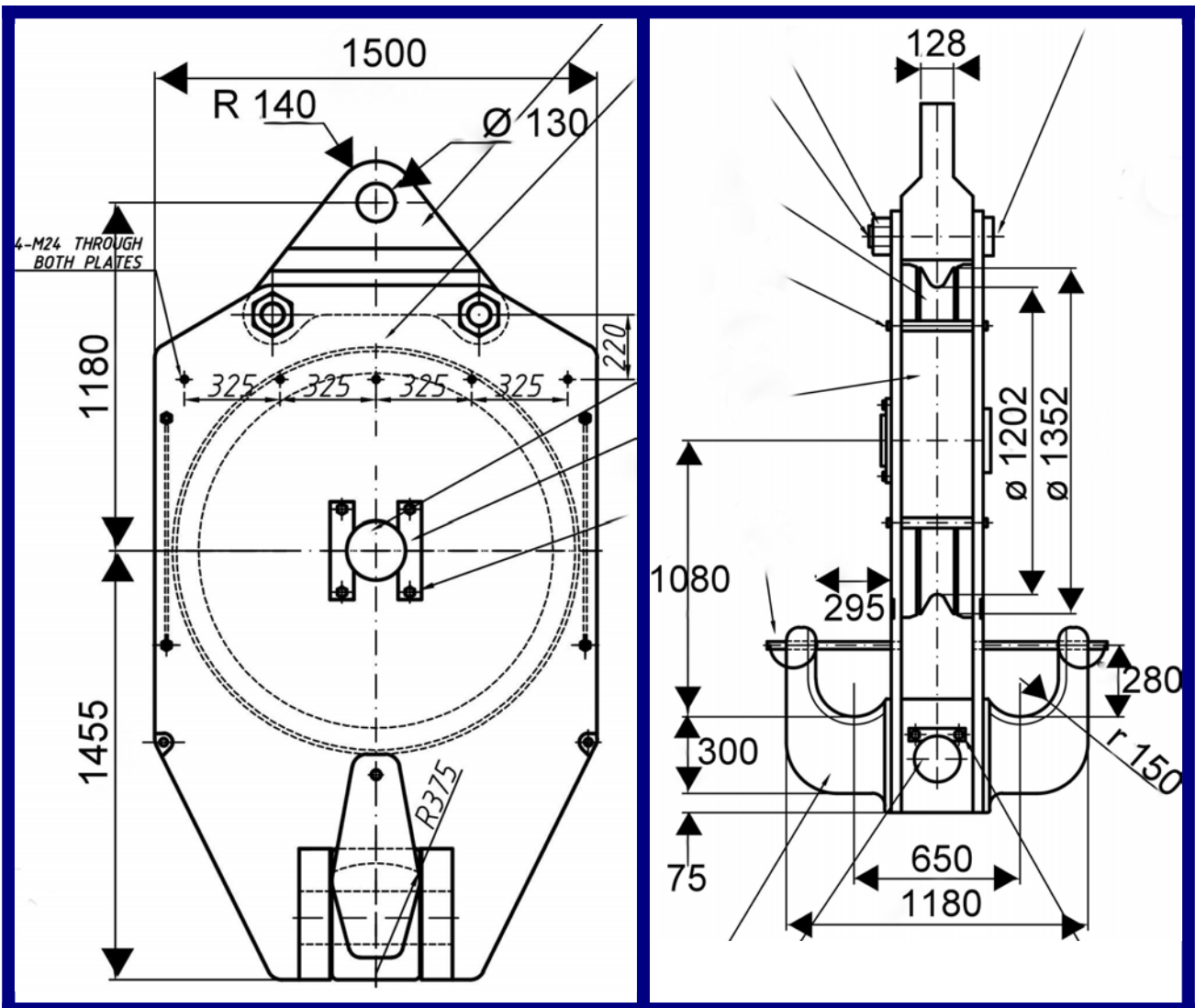

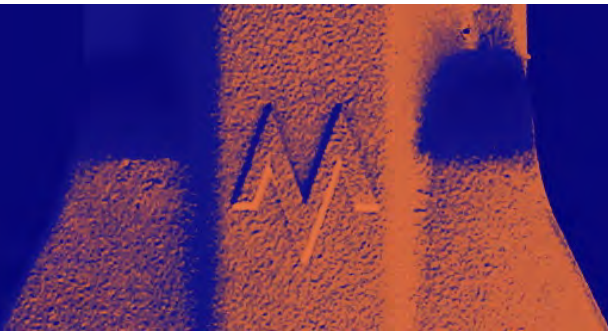

Model A3- 0901
 Triple-sheaved block
 WLL: 90 tons
 For \varnothing 30 mm wire

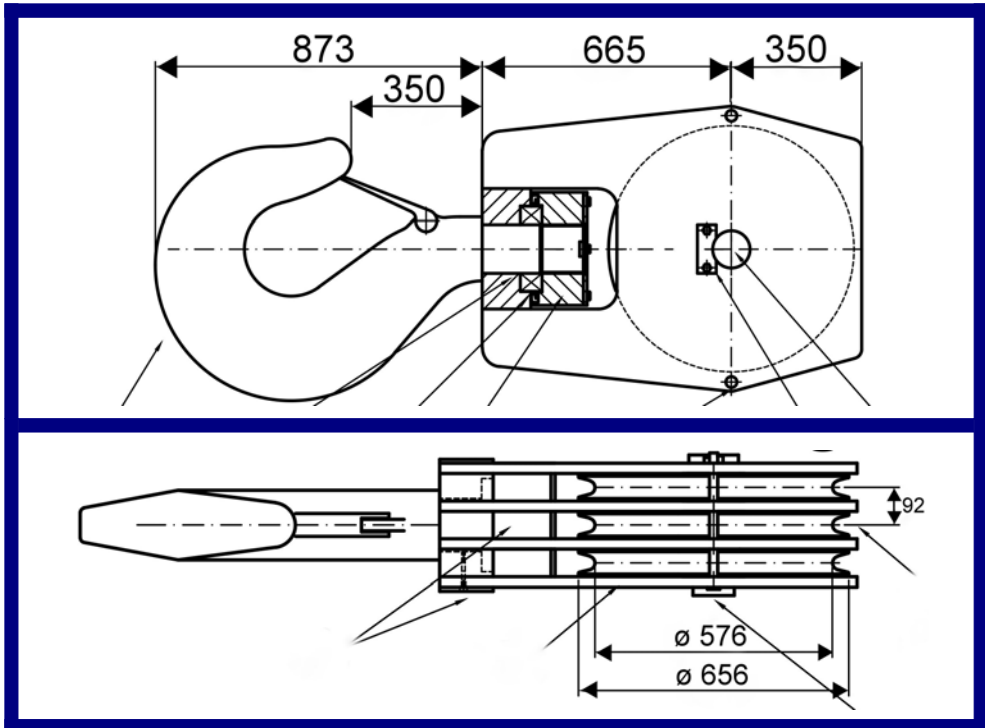

Model A3- 0905
 Single sheaved block
 DL: 100 tons in hook

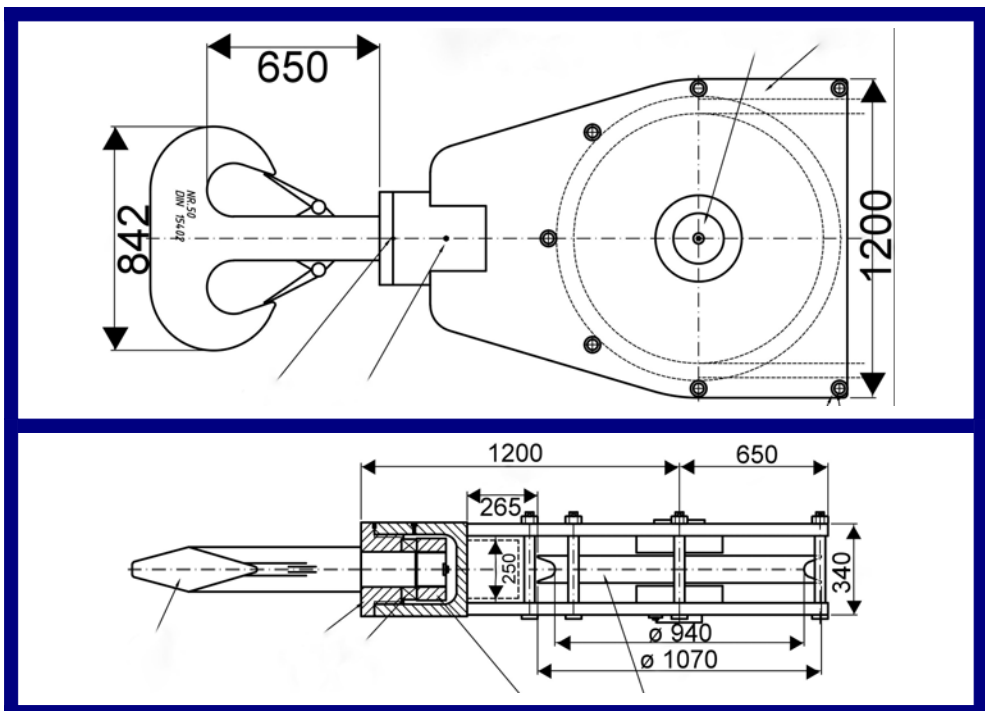

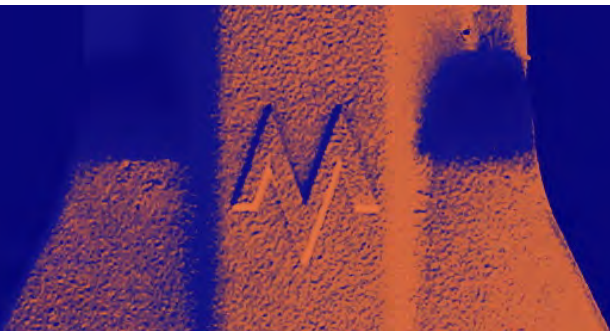

Model A3- 1051
 Five-sheaved cargo block
 DL: 200 tons

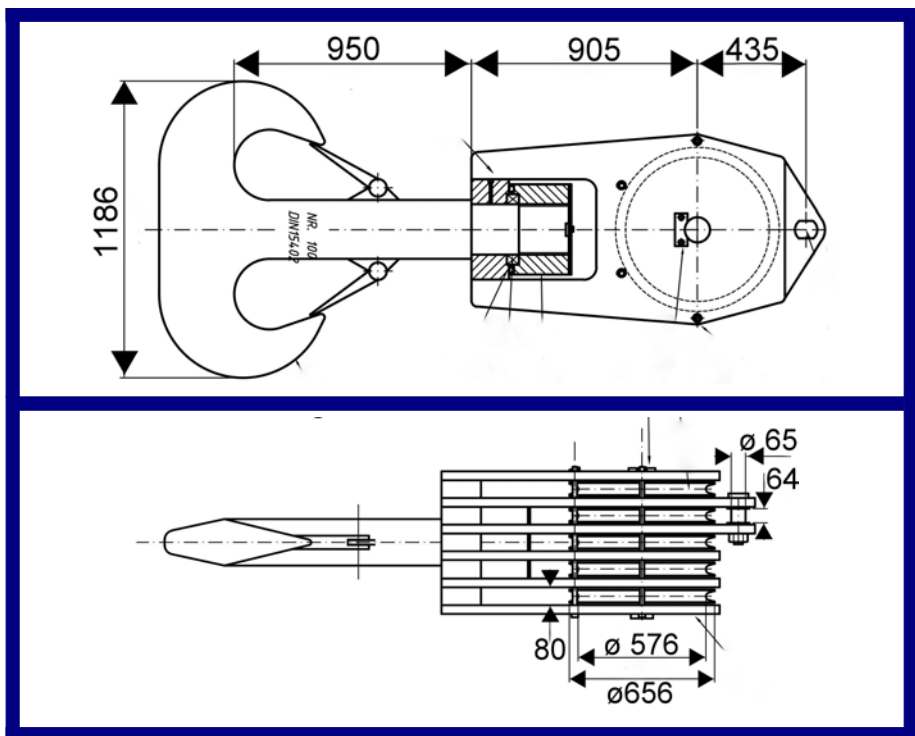

Model A3- 1059
 Swivel
 WLL=DL 100 tons

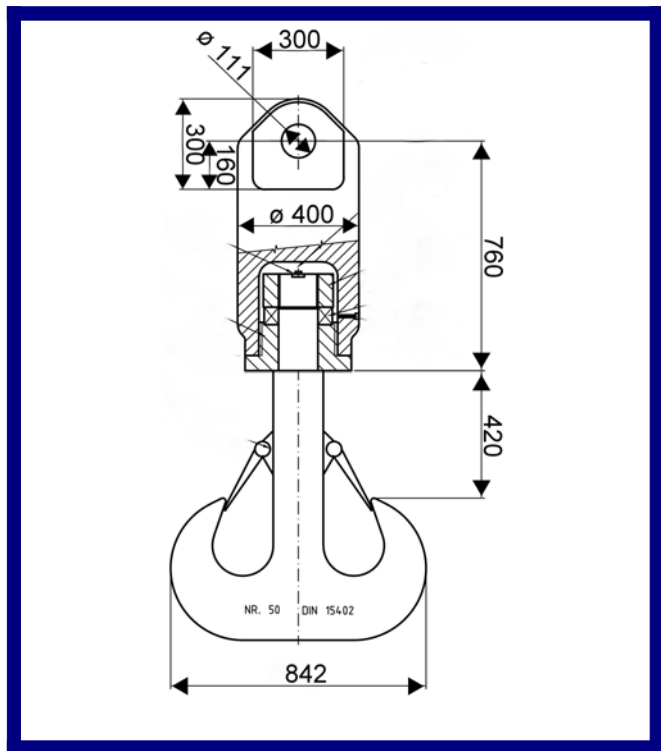
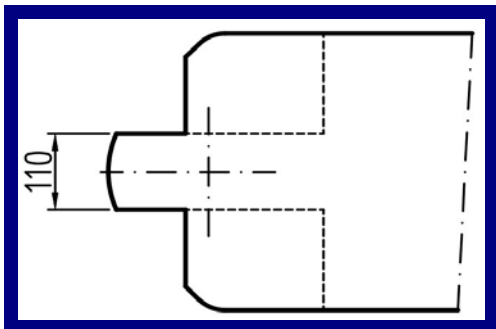

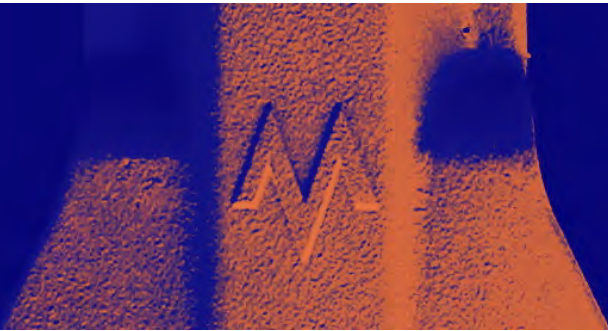

Model A3- 1147

Double sheaved block
 DL: 100 tons
 For \varnothing 34 mm wire

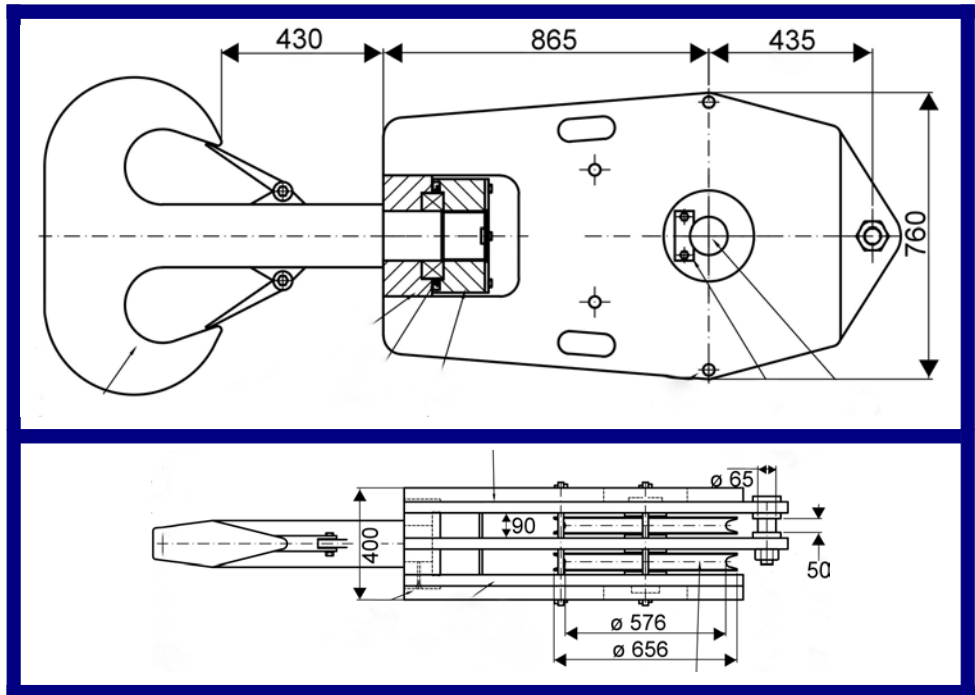

Model A3- 1251B

Single sheaved block
 For \varnothing 63 mm wire
 SWL: 75 tons in wire
 SWL: 150 tons in hook
 Design load:
 150 tons in hook

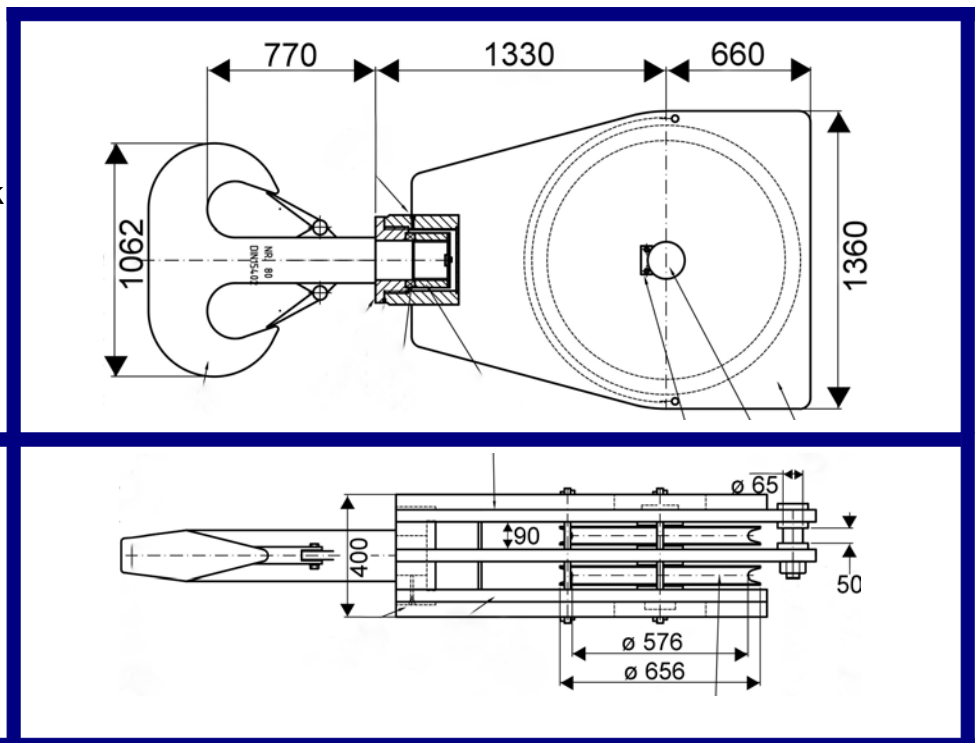

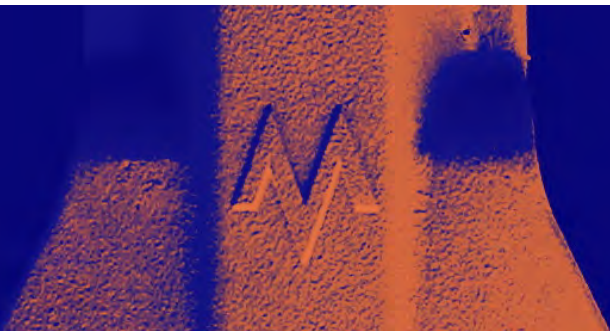

Model A3- 1265
Tandem-block
SWL: 200 tons

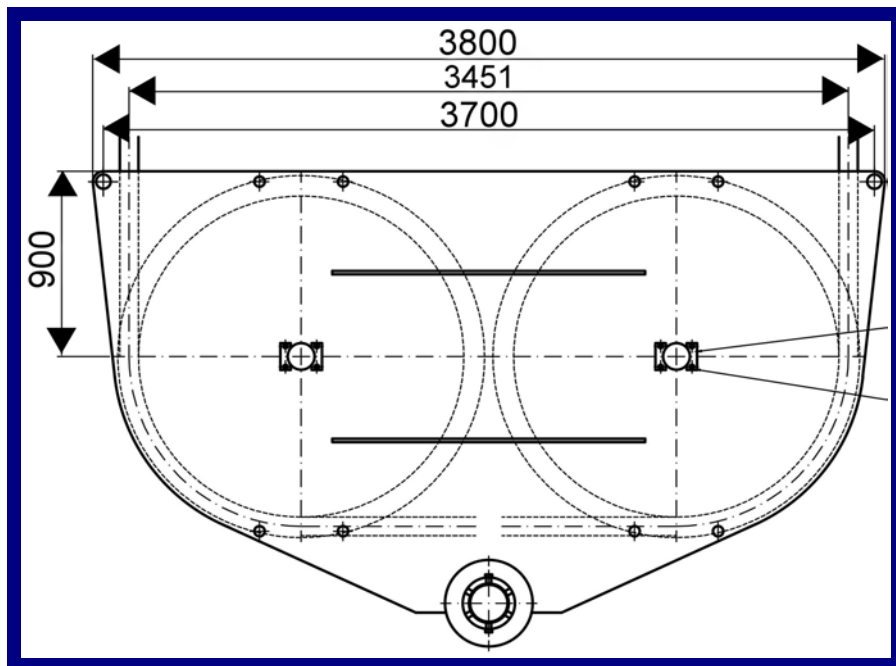
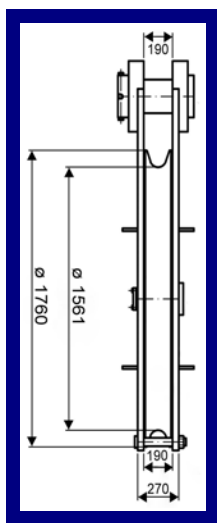

Model A3- 1312
Wireline block
For \varnothing 12 mm wire
Wirepull: 10 tons
Load test: 20 tons

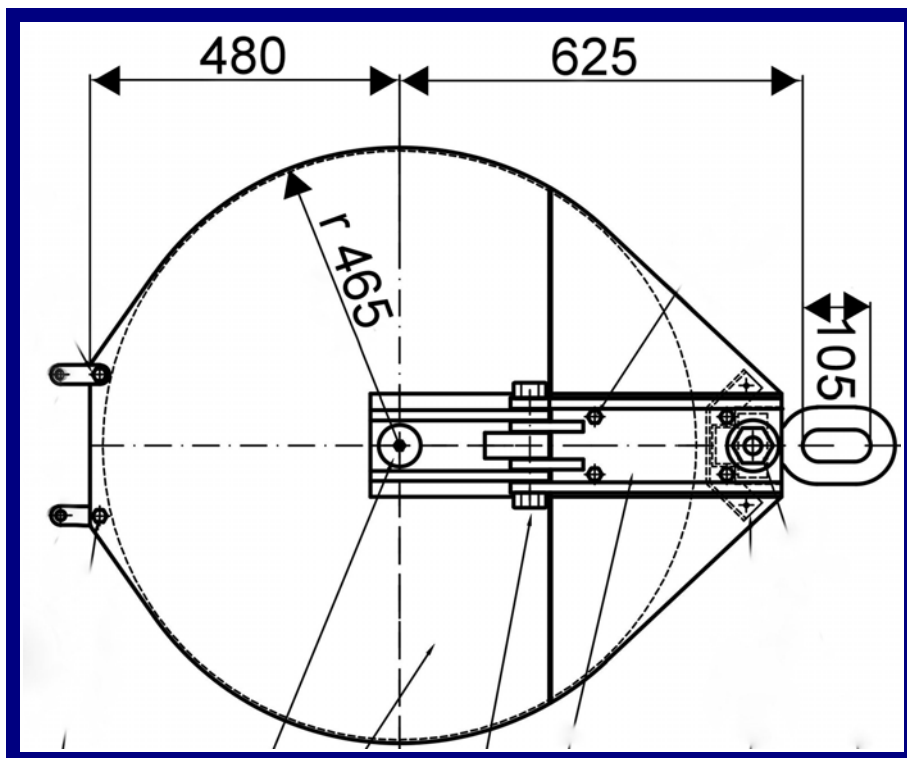
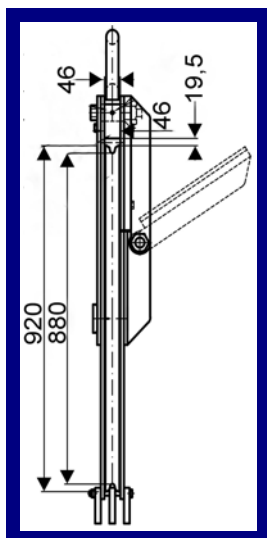

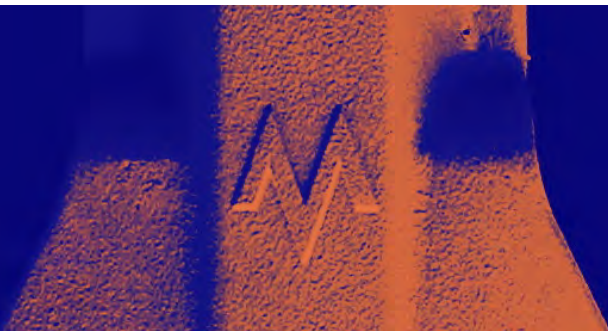

Model A3- 1372B
Swivel with double
hook
DL=SWL: 250 tons

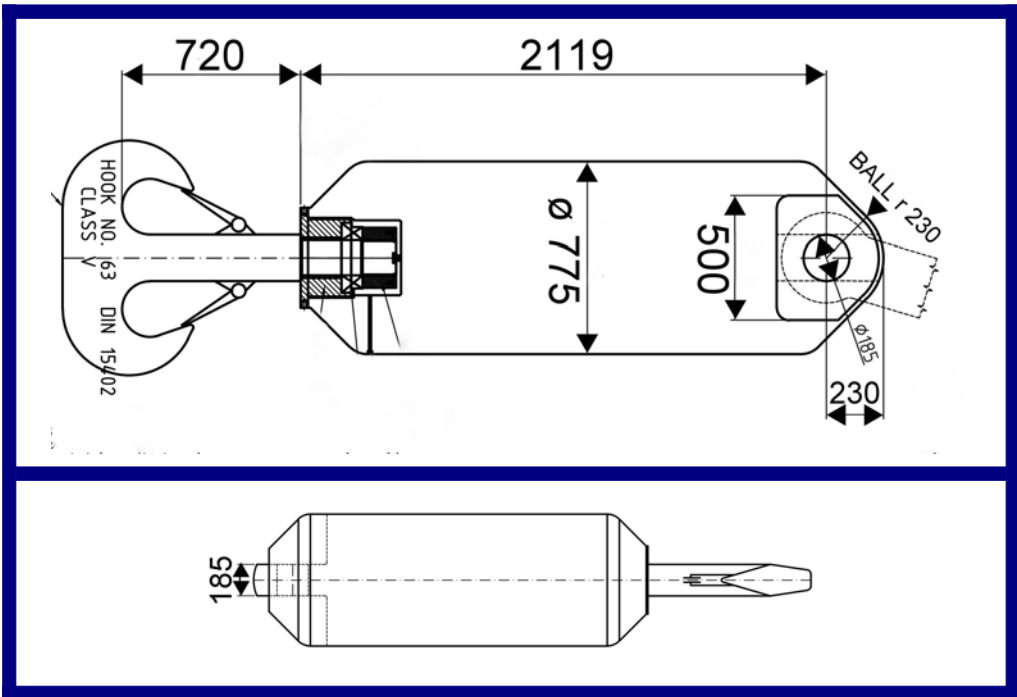

Model A3- 1417
Single sheaved
block
SWL: 125 tons
For \varnothing 77 mm wire

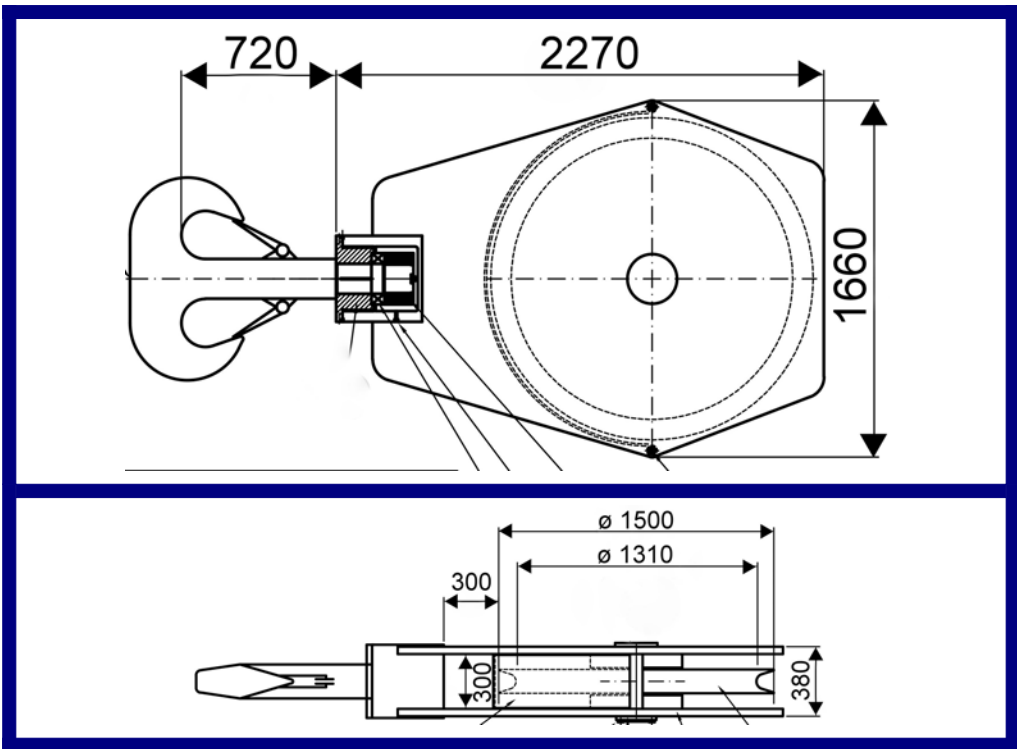

Model A3- 1470

Snatch block for 1/4" tube
Max line pull: 6 tons, test 12 tons

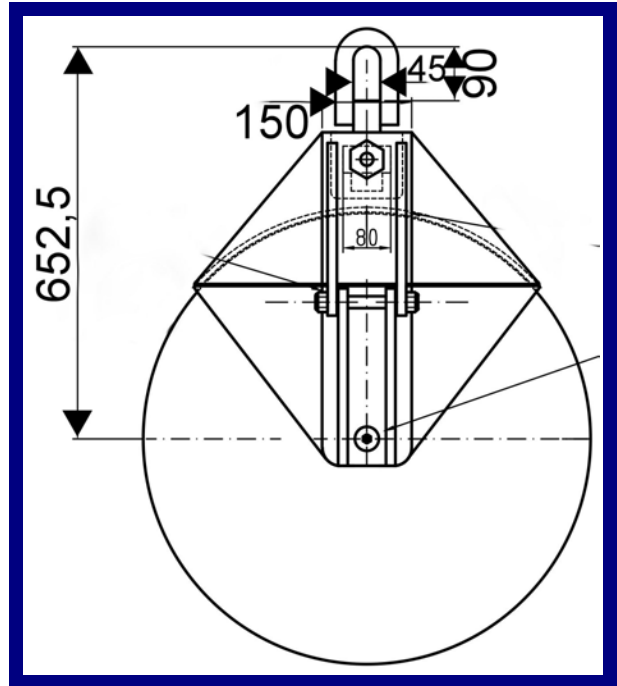
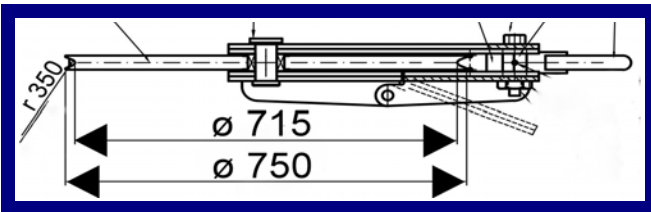

Model A3- 1510

Single sheaved block
For $\varnothing\ 75\text{ mm}$ wire
SWL: 300 tons in eye
MBL: 1500 tons

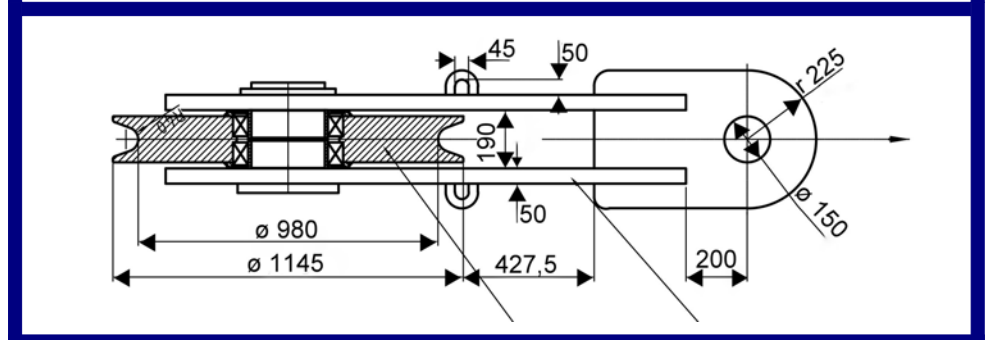
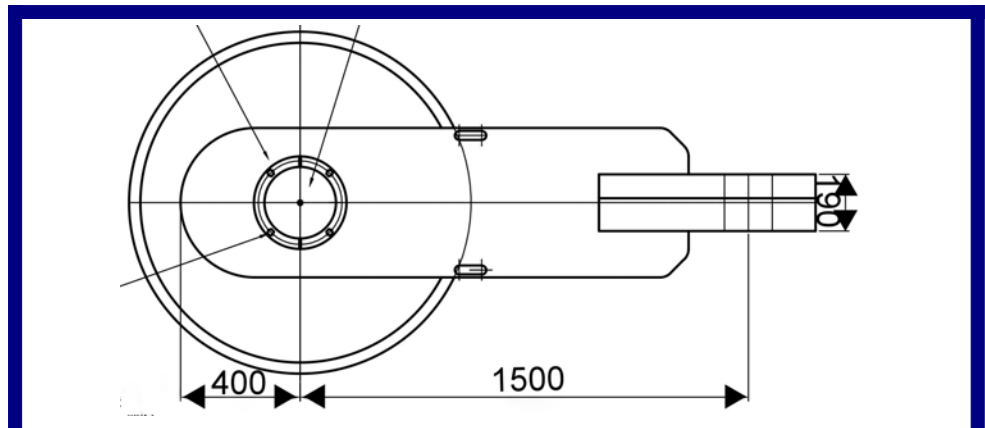

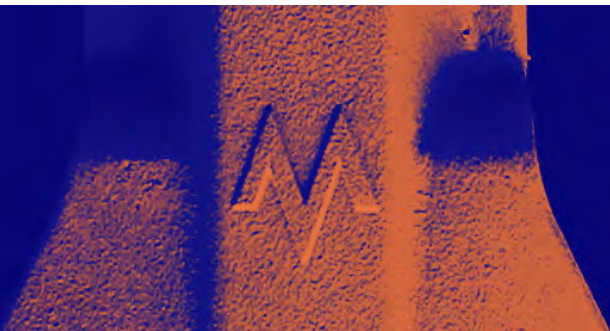

Model A3- 1512
 Triple sheaved block
 with hook
 SWL: 25 tons
 For \varnothing 19 mm wire

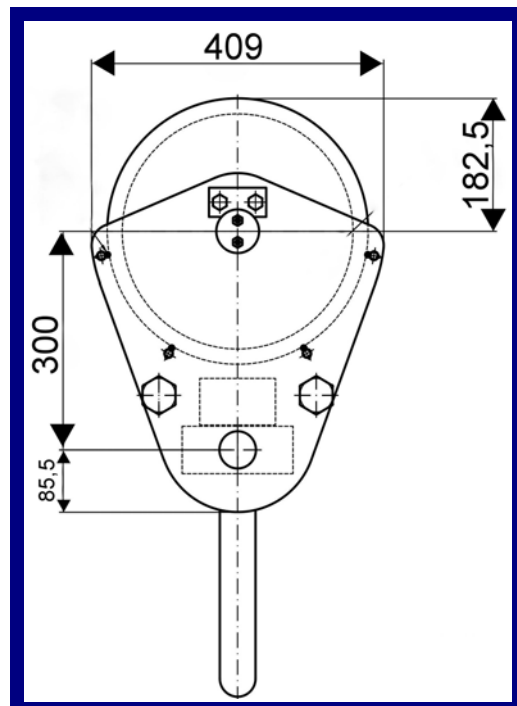
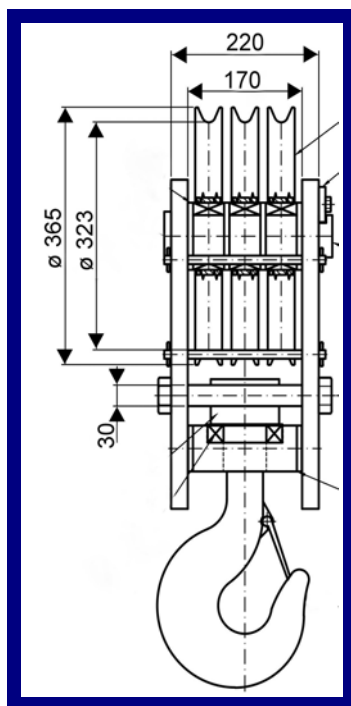

Model A3- 1726
 Banana-sheave
 WLL 3 tons in cable
 SF=5
 Work angle: 30- 180
 degrees.

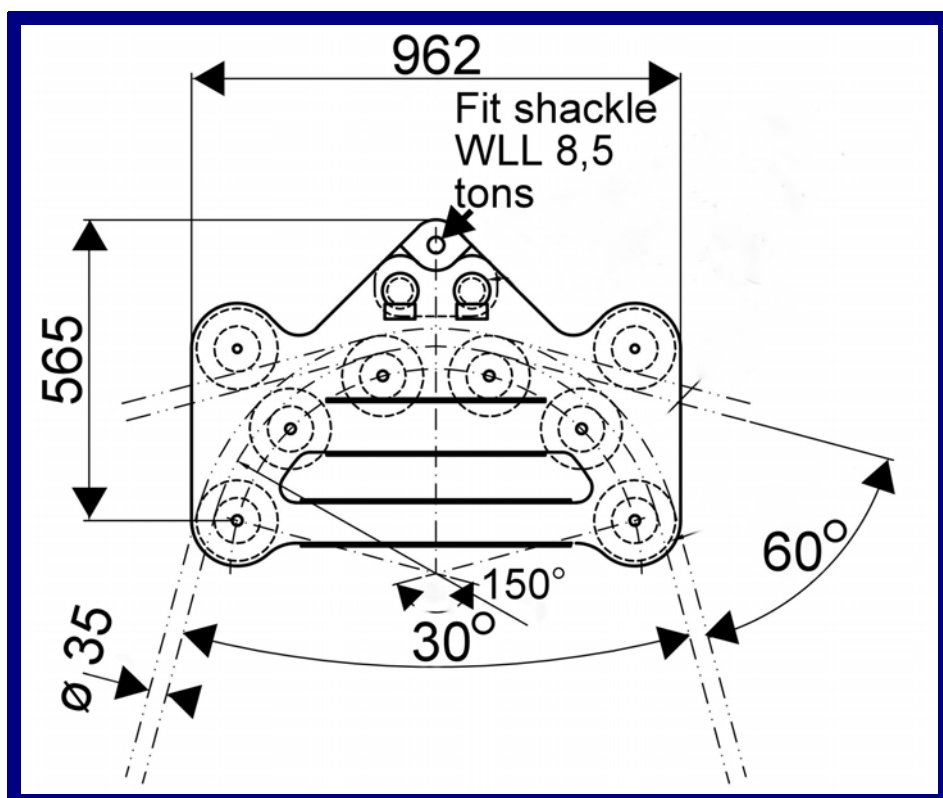
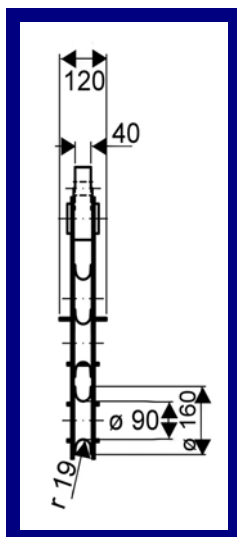

Model A3- 2026

Multi-sheaved pod hose 90 degrees

WLL: 3 tons, 6 tons in eye,

SF= 5

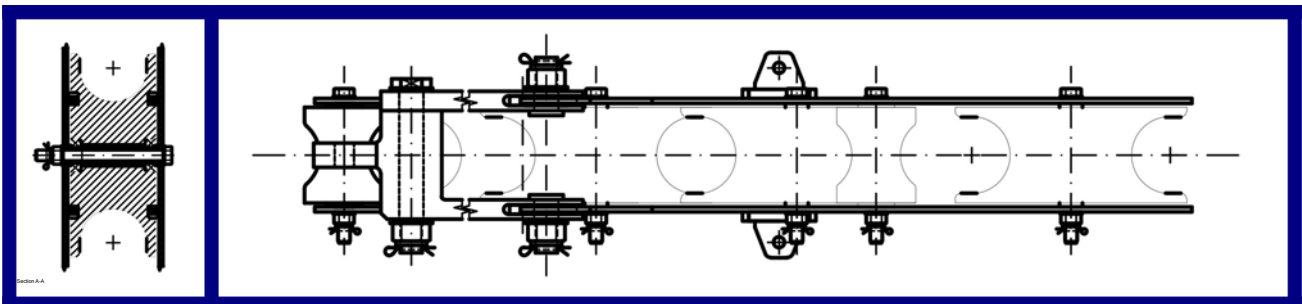
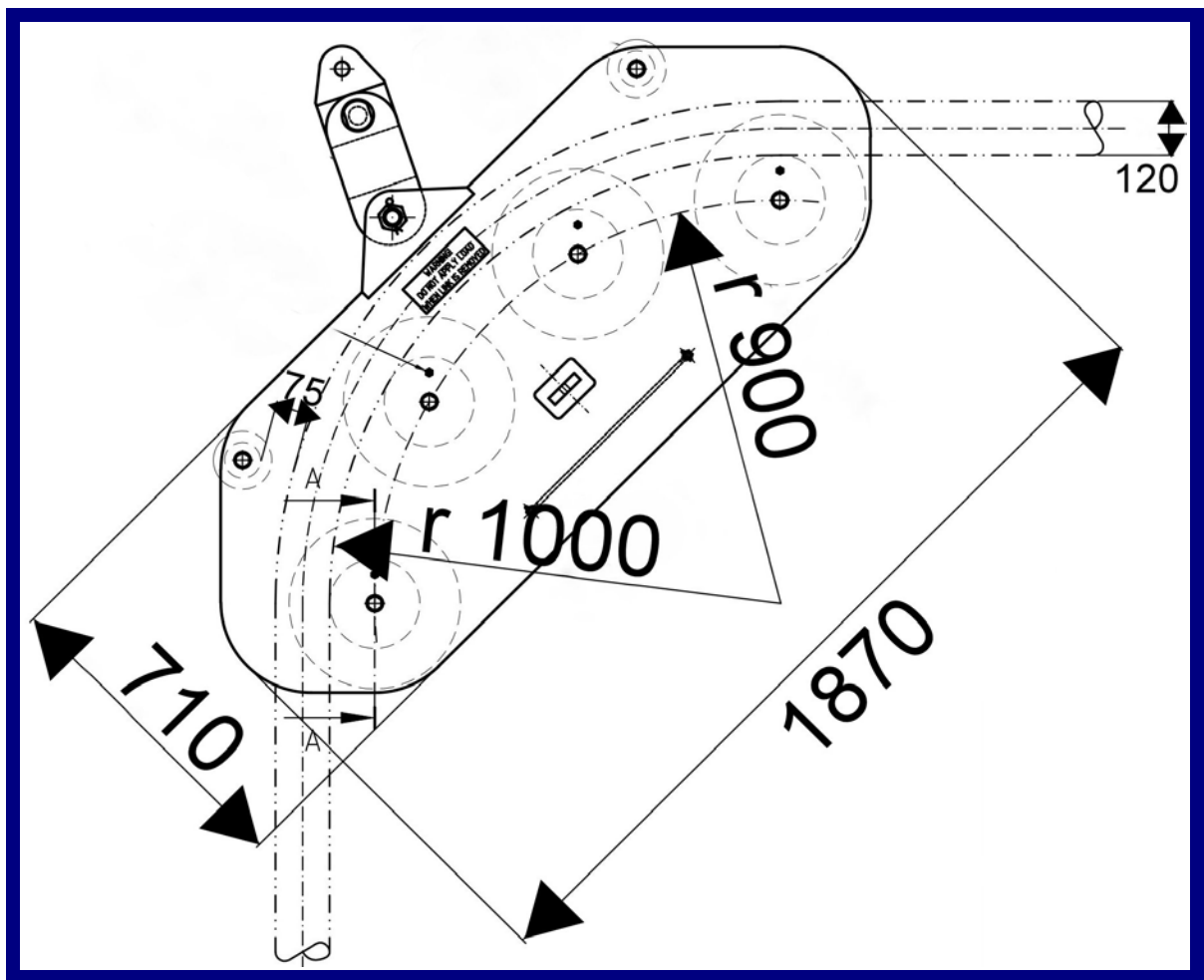

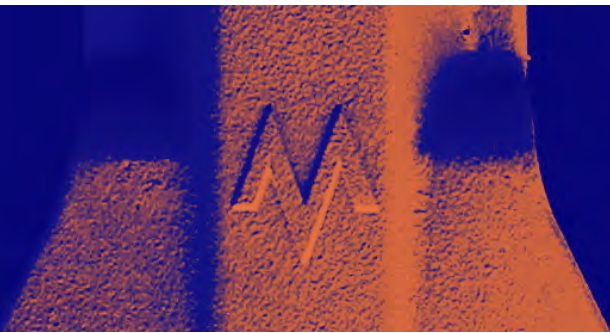

Model A4- 3701 WEB
Streamer lead-in cable collar

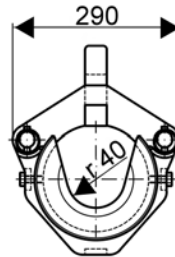
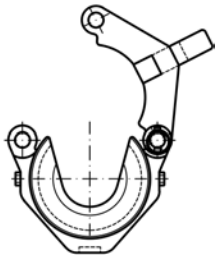
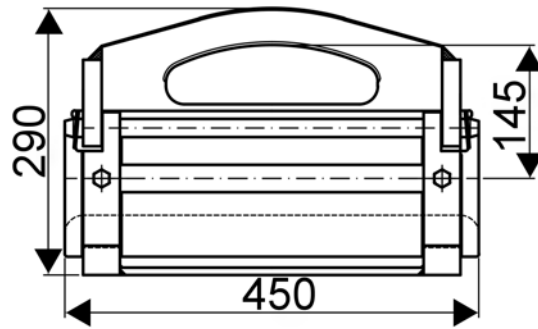

Model A4- 3871
Swivel
DL: 30 tons

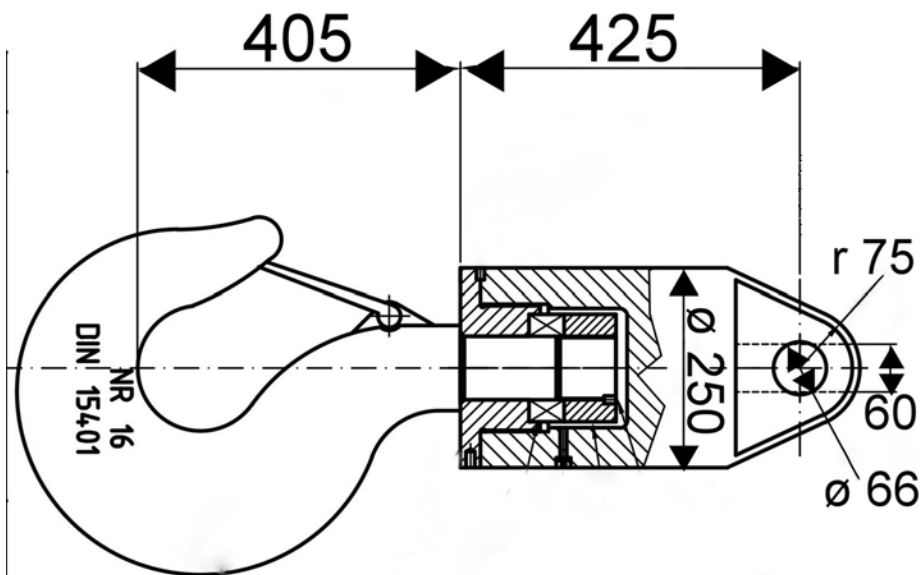

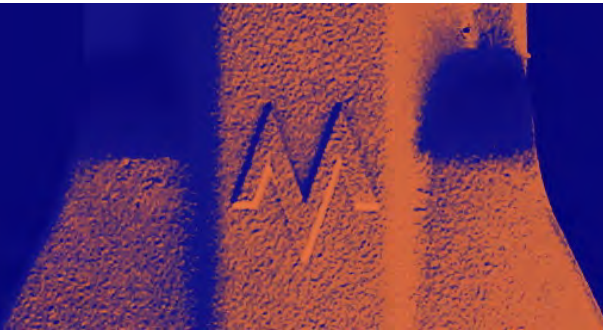

Model A4- 3860

Swivel with double hook
DL=SWL: 200 tons

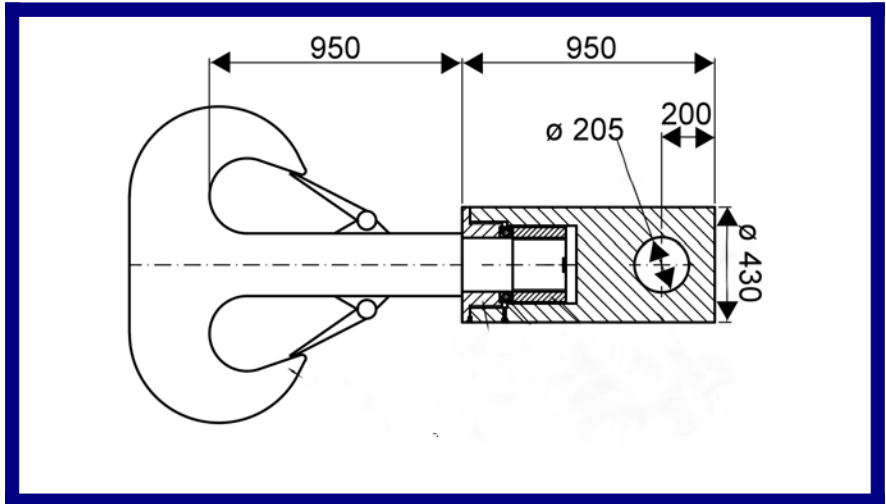
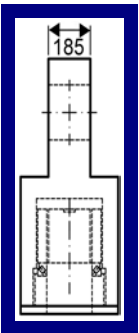

Model A4- 4834

Snatch block with trawl-
sheave
WLL: 5 tons,
Max. Bearing load: 7,5 tons

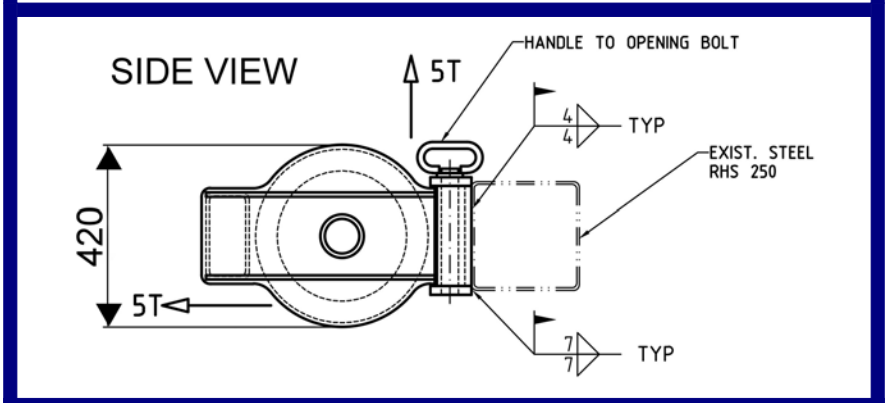
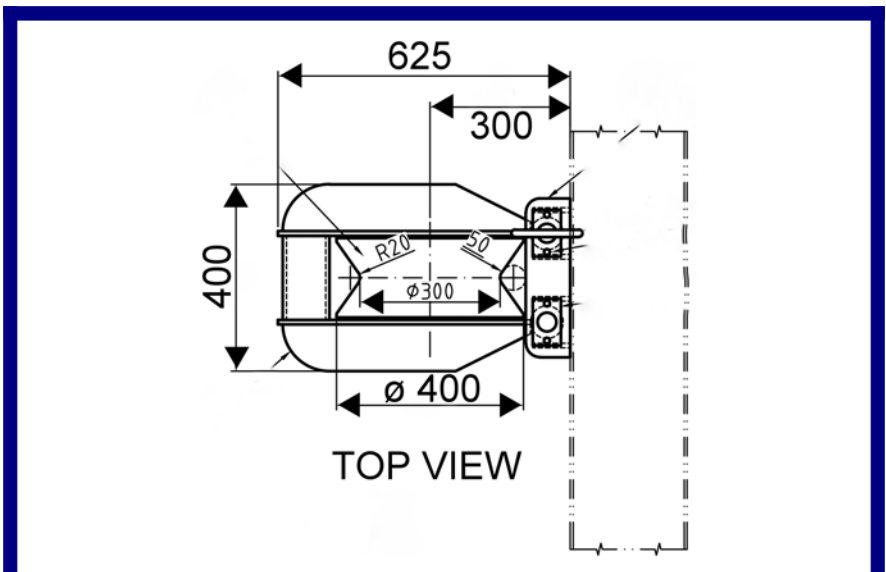

Model A4- 5272

Double-sheaved block

SWL: 40 tons

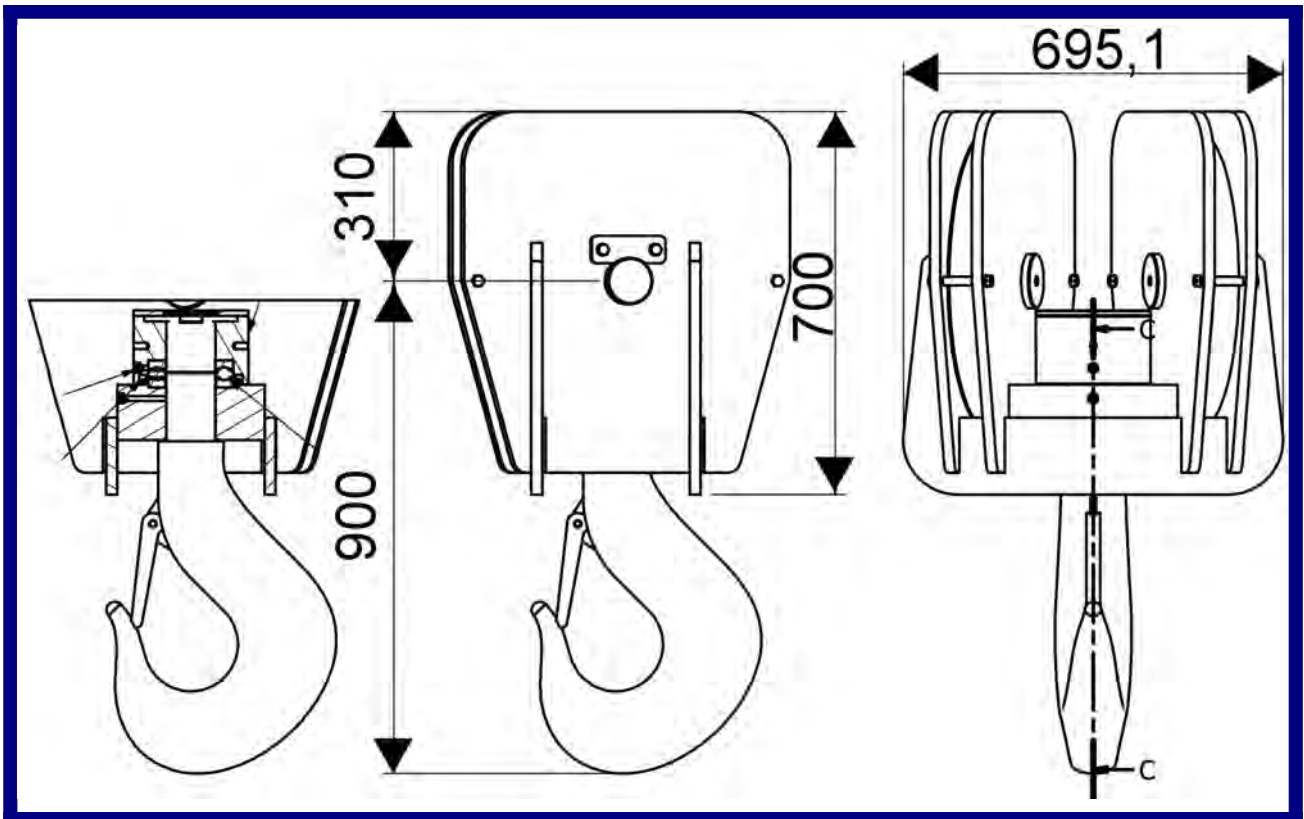
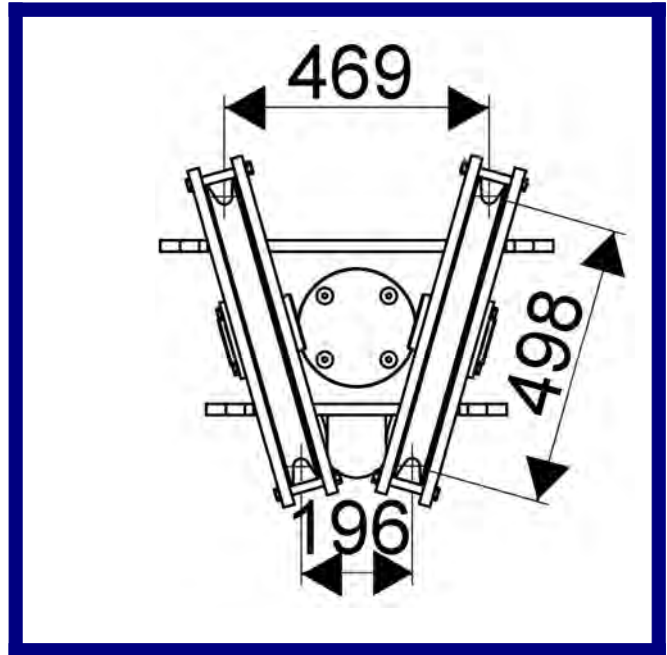
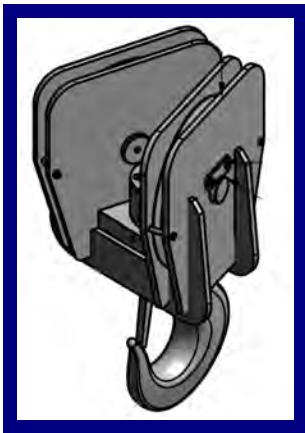



Model A4- 5217

Block with two pieces, 12" wiresheave
SWL: 10 tons in swivel oval eye

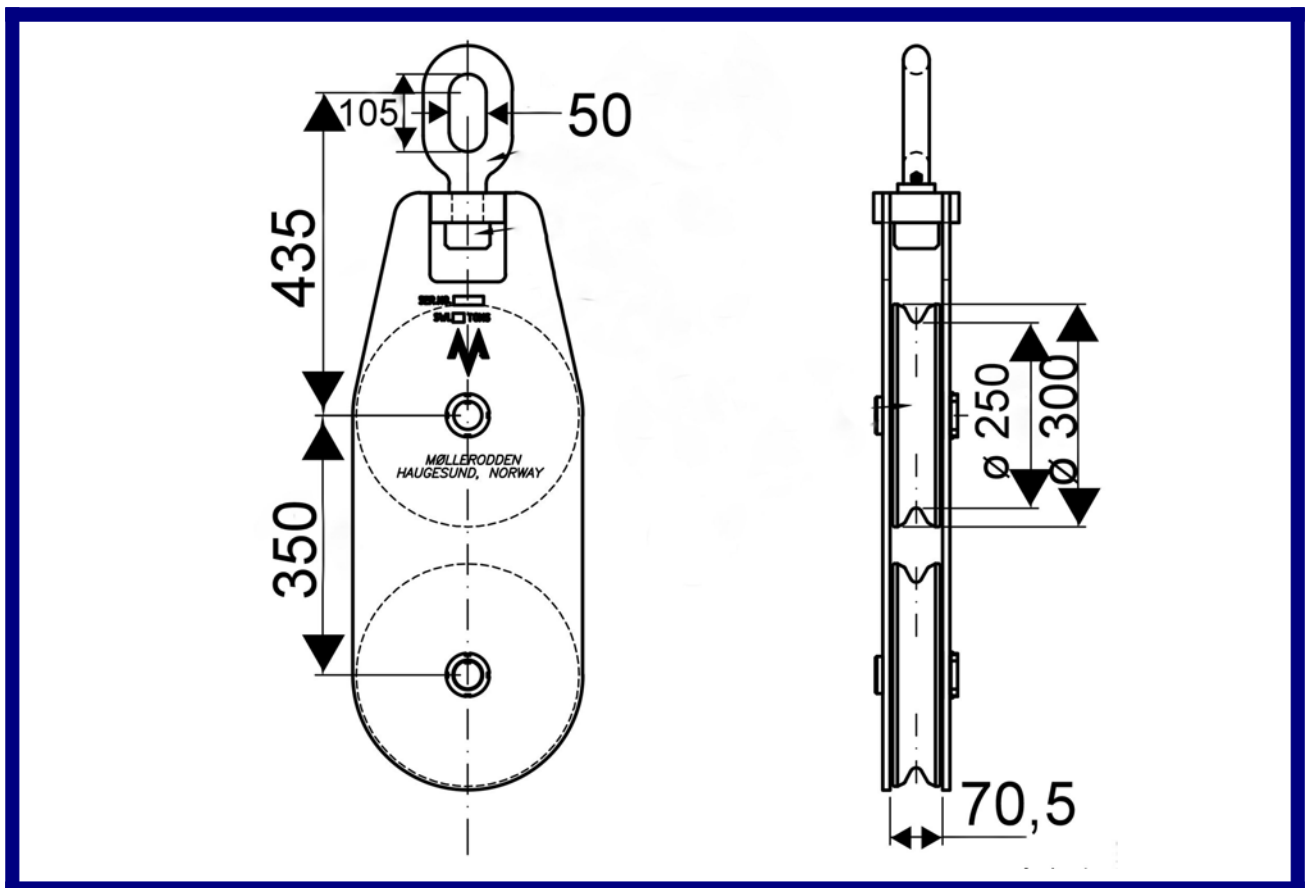



Tel: (+ 47) 52 70 31 00 Fax: (+ 47) 52 70 31 25 E-mail: post@mollerodden.no
Møllerodden AS, Longhammarvegen 15, 5536 Haugesund, Org.no: 996831523